

N
FOR FINISH SCHEDULE
REFERENCE ONLY

SEE A-6 FOR
LARGE PLAN

SEE A-7 FOR
LARGE PLAN

SEE A-5 FOR
LARGE PLAN

FIRST FLOOR PLAN

ALL DIMENSIONS ARE FROM FACE OF STUD
TO FACE OF STUD OR FACE OF STUD TO
FACE OF BRICK.

SCALE: 1/8" = 1'-0"

ALL WALLS ARE 3/8" UNLESS NOTED OTHERWISE

--- 1 HOUR RATED WALLS

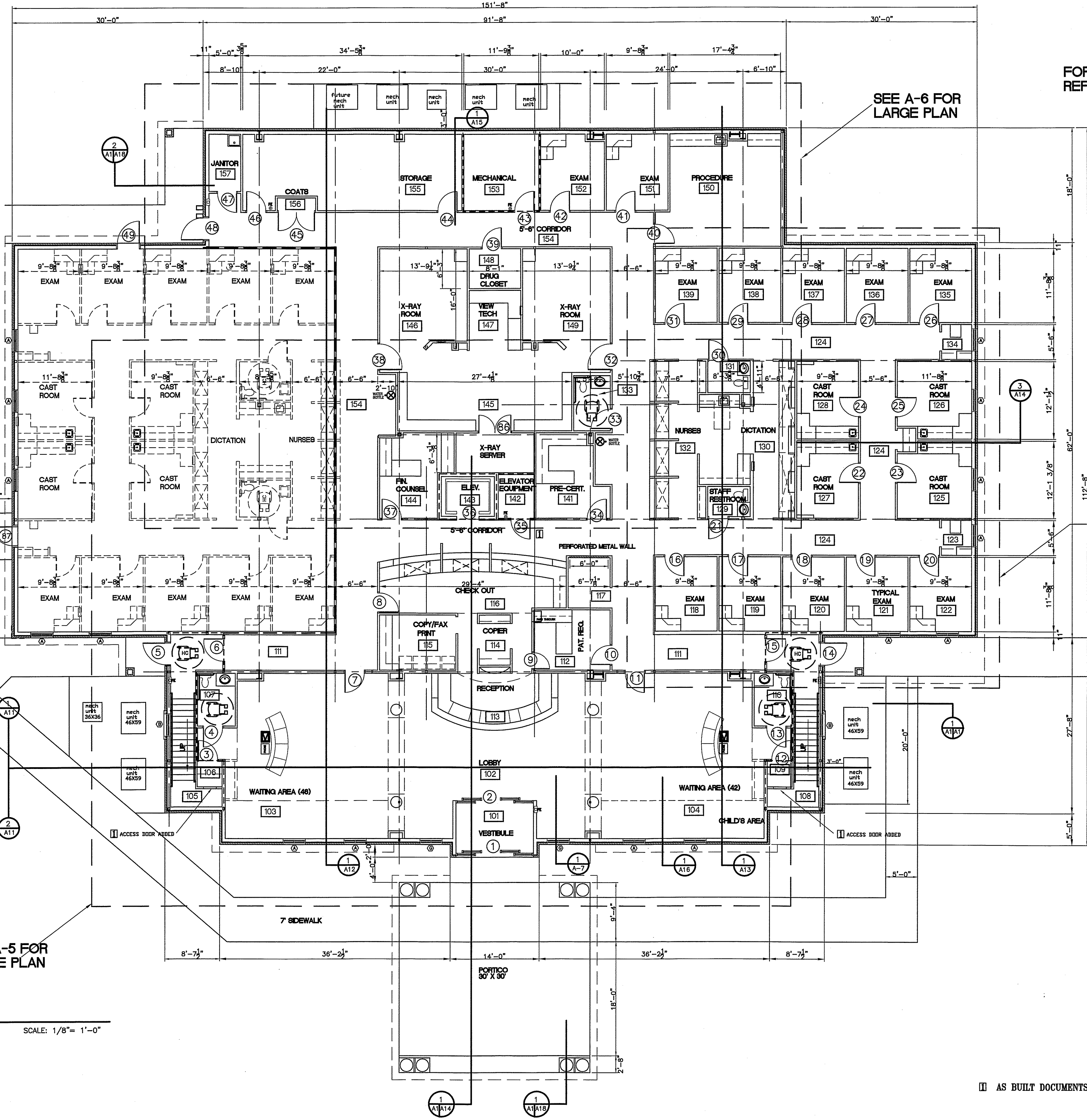

Drawn: HEM	No.:	Date:	By:
Checked: JTB	3	3/27/03	View boxes/Work room/CLB
Date: 12/04/02			door and wall changes
Arch. Proj. # 0237			

A NEW OFFICE FOR
ALBANY ORTHOPEDIC CENTER
ALBANY, GA

YMA
Yielding
Wakeford & McGee Architects, P.C.

116 Roosevelt Avenue, Suite 200 / P.O. Box 405 / Albany, Georgia 31702 / (912)435-0036

Sheet No. of
1 27

Drawing

A-1

AS BUILT DOCUMENTS REVISED 1/14/04

SECOND FLOOR PLAN

SCALE: 1/8" = 1'-0"

ALL DIMENSIONS ARE FROM FACE OF STUD TO FACE OF STUD OR FACE OF STUD TO FACE OF BRICK.

ALL WALLS ARE 3 5/8" UNLESS NOTED OTHERWISE

————— 1 HOUR RATED WALL

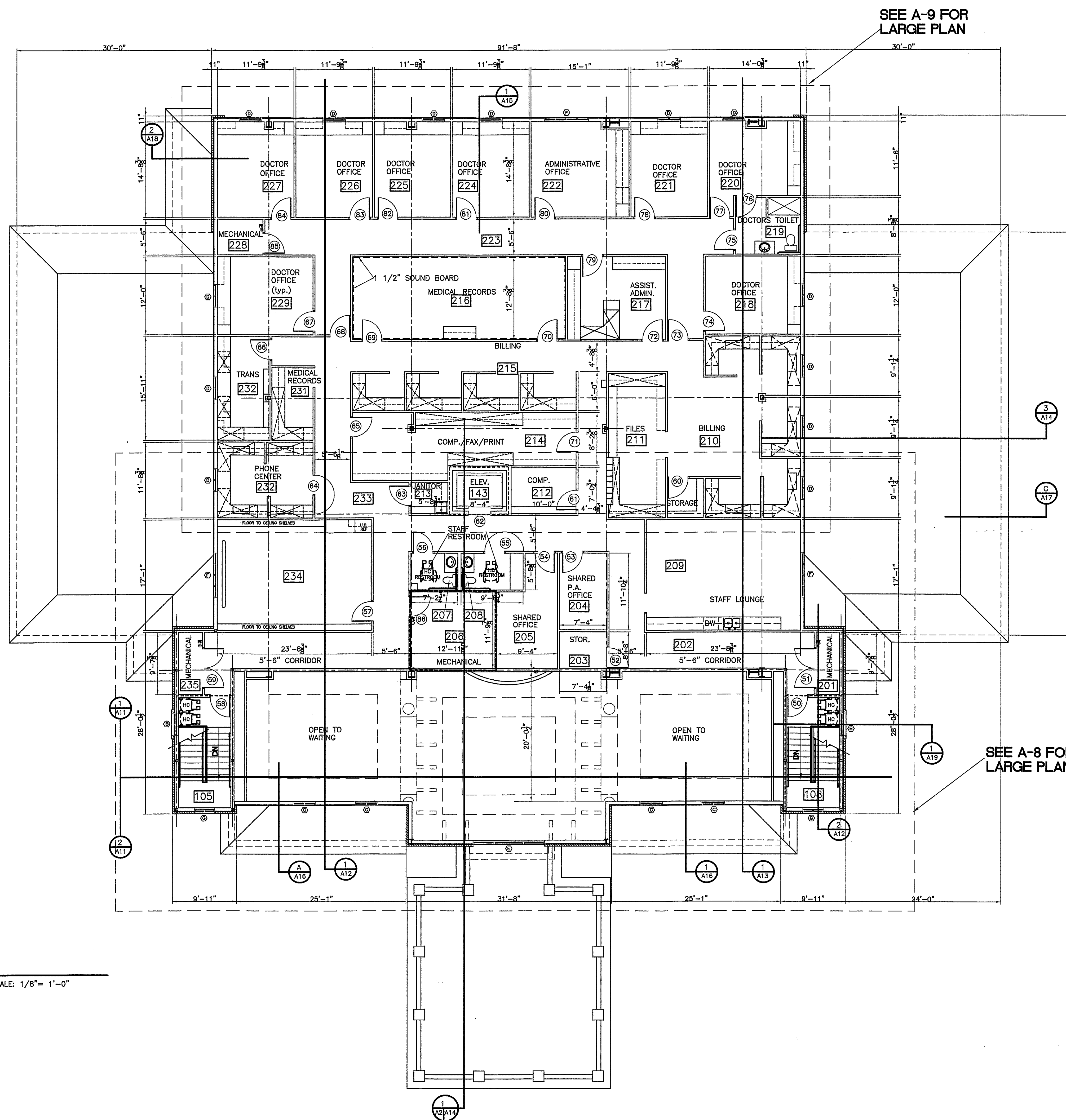

N
FOR FINISH SCHEDULE
REFERENCE ONLY

Drawn:	HHM	No.	Date	Revisions
Checked:		1	3-19-03	Remove view boxes
Date:	12/04/02	3	4/02/03	Sound board
Arch. Proj. #	0237			

A NEW OFFICE FOR
ALBANY ORTHOPEDIC CENTER
ALBANY, GA

Yielding
Wakeford & McGee Architects, P.C.

Sheet No. 0f

Drawing
A-2

116 Roosevelt Avenue, Suite 200 / P.O. Box 405 / Albany, Georgia 31702 / (912)435-0036