

Agent 360

1259 Reading Ave, Boyertown, PA 19512-8186

Douglas Twp

Tax ID 41-5376-04-54-6520

Public Records

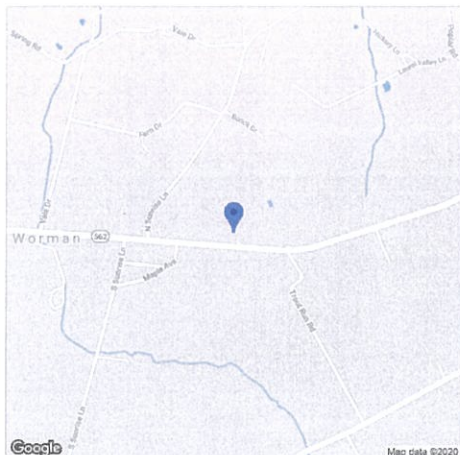

Summary Information

Owner:	Dennis & Judy Urffer	Property Class:	Residential
Owner Address:	1259 Reading Ave	Annual Tax:	\$4,739
Owner City State:	BOYERTOWN PA	Record Date:	11/30/93
Owner Zip+4:	19512-8186	Sale Amount:	\$113,900
Owner Occupied:	Yes	Book:	2484
No Mail(P):	No	Page:	212
Owner Carrier Rt:	R007	Tax Record Updated:	02/12/20

Geographic Information

County:	Berks, PA	Lot:	6520
Municipality:	Douglas Twp	Grid:	7420C6
High Sch Dist:	Boyertown Area	Census:	0130.003
Tax ID:	41-5376-04-54-6520	Sub Plot Book:	197
Tax Map:	5376-04	Sub Plot Page:	46
Ward:	0		
Block:	54		
Tax Act Num:	41072990		
Sub Lot Num:	2		

Assessment & Tax Information

Tax Year:	2020	Annual Tax:	\$4,739	Total Land Asmt:	\$45,000
County Tax:	\$904	Taxable Land Asmt:	\$45,000	Total Bldg Asmt:	\$73,000
Municipal Tax:	\$507	Taxable Bldg Asmt:	\$73,000	Total Asmt:	\$118,000
School Tax:	\$3,328			Taxable Total Asmt:	\$118,000
Assessor Lnd Mkt:	\$45,000				

Lot Characteristics

Sq Ft:	43,124	County Location:	Neighborhood/Spot
Acres:	0.9900		
Roads:	Paved		
Topography:	Level		

Building Characteristics

Total SQFT:	1,638	Total Rooms:	7	Basement Type:	Full
Residential Type:	Single/Det	Bed Rooms:	4	Garage Type:	Detached
Residential Design:	1.5 Story	Full Baths:	2	Gas:	None
Stories:	1.50	Total Baths:	2.0	Water:	Well/Pvt
Total Units:	1	Family Room:	0	Sewer:	On Site Septic
Abv Grd Fin SQFT:	1,638	Exterior:	Frame	Year Built:	1950
Fireplace Total:	0	Heat Delivery:	Hot Water/Steam	Heat Fuel:	Oil
Attic Type:	None				
Porch/Deck:	Porch				
Bldg Condition:	Average				

Codes & Descriptions

Land Use: 106 Res: 1 Fam, 1.5 Sty, Frame

MLS History

Tax History

Year	County	Annual Tax Amounts			Annual
		Municipal	School		
2020	\$904	\$507	\$3,328	\$4,739	
2019	\$904	\$507	\$3,225	\$4,636	
2018	\$904	\$507	\$3,112	\$4,523	
2017	\$870	\$389	\$2,952	\$4,212	
2016	\$870	\$389	\$2,864	\$4,123	
2015	\$870	\$271	\$2,827	\$3,969	
2014	\$870	\$271	\$2,760	\$3,901	
2013	\$870	\$236	\$2,657	\$3,763	
2012	\$818	\$236	\$2,582	\$3,636	
2011	\$818	\$236	\$2,582	\$3,636	
2010	\$818	\$236	\$2,451	\$3,505	
2009	\$818	\$236	\$2,362	\$3,417	
2008	\$818	\$236	\$2,318	\$3,372	
2007	\$818	\$236	\$2,270	\$3,325	
2006	\$818	\$236	\$2,263	\$3,318	
2005	\$818	\$236	\$2,296	\$3,351	
2004	\$612	\$236	\$2,120	\$2,968	
2003	\$612	\$236	\$1,975	\$2,823	

Year	Annual Assessment					Total Asmt
	Land	Building	Ttl Taxable	Total Land	Total Bldg	
2020	\$45,000	\$73,000	\$118,000	\$45,000	\$73,000	\$118,000
2019	\$45,000	\$73,000	\$118,000	\$45,000	\$73,000	\$118,000
2018	\$45,000	\$73,000	\$118,000	\$45,000	\$73,000	\$118,000
2017	\$45,000	\$73,000	\$118,000	\$45,000	\$73,000	\$118,000
2016	\$45,000	\$73,000	\$118,000	\$45,000	\$73,000	\$118,000
2015	\$45,000	\$73,000	\$118,000	\$45,000	\$73,000	\$118,000
2014	\$45,000	\$73,000	\$118,000	\$45,000	\$73,000	\$118,000
2013	\$45,000	\$73,000	\$118,000	\$45,000	\$73,000	\$118,000
2012	\$45,000	\$73,000	\$118,000	\$45,000	\$73,000	\$118,000
2011	\$45,000	\$73,000	\$118,000	\$45,000	\$73,000	\$118,000
2010	\$45,000	\$73,000	\$118,000	\$45,000	\$73,000	\$118,000
2009	\$45,000	\$73,000	\$118,000	\$45,000	\$73,000	\$118,000
2008	\$45,000	\$73,000	\$118,000	\$45,000	\$73,000	\$118,000
2007	\$45,000	\$73,000	\$118,000	\$45,000	\$73,000	\$118,000
2006	\$45,000	\$73,000	\$118,000	\$45,000	\$73,000	\$118,000
2005	\$45,000	\$73,000	\$118,000	\$45,000	\$73,000	\$118,000
2004	\$45,000	\$73,000	\$118,000	\$45,000	\$73,000	\$118,000
2003	\$45,000	\$73,000	\$118,000	\$45,000	\$73,000	\$118,000

Sale & Mortgage

Record Date: 11/30/1993 Book: 2484
 Settle Date: Page: 212
 Sales Amt: \$113,900 Doc Num:
 Sale Remarks:
 Owner Names: Dennis & Judy Urffer

Mort Rec Date: 11/12/2009 Lender Name: VICTORY BK
 Mort Date: 11/03/2009 Term: 0
 Mort Amt: \$100,000 Due Date:
 Remarks: Conv, Home Equity Loan

Mort Rec Date: 07/10/2003 Lender Name: NATIONAL PENN BK
 Mort Date: 06/06/2003 Term: 0
 Mort Amt: \$50,000 Due Date:

Remarks: Conv, Fixed, Home Equity Loan

Mort Rec Date: 01/29/2003 Lender Name: NATIONAL PENN BK
 Mort Date: 12/14/2002 Term: 0
 Mort Amt: \$16,000 Due Date:
 Remarks: Conv, Fixed, Refinance

Mort Rec Date: 06/12/2003 Lender Name: PENN FIRST FINL SVCS INC
 Mort Date: 05/09/2003 Term: 15
 Mort Amt: \$80,000 Due Date: 06/01/2018
 Remarks: Conv, Fixed, Refinance

Flood Report

Flood Zone in Center of Parcel: X
 Flood Code Desc: Zone X-An Area That Is Determined To Be Outside The 100- And 500-Year Floodplains.
 Flood Zone Panel: 42011C0560G Panel Date: 07/03/2012
 Special Flood Hazard Area (SFHA): Out
 Within 250 feet of multiple flood zone: No

Public Record Only-Property History

Property History

Source	Category	Status	Date	Price	Owner
Public Records		Record Date	11/30/1993	\$113,900	Dennis & Judy Urffer

Maps

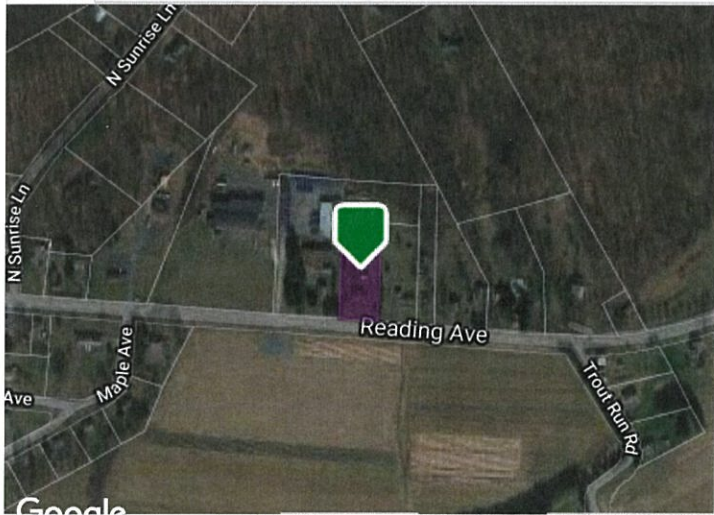

Google Earth Resources-PAMAP/USGS, U 200 ft. Logical Survey, USDA F. Report a map error



Google

200 ft

Report a map error

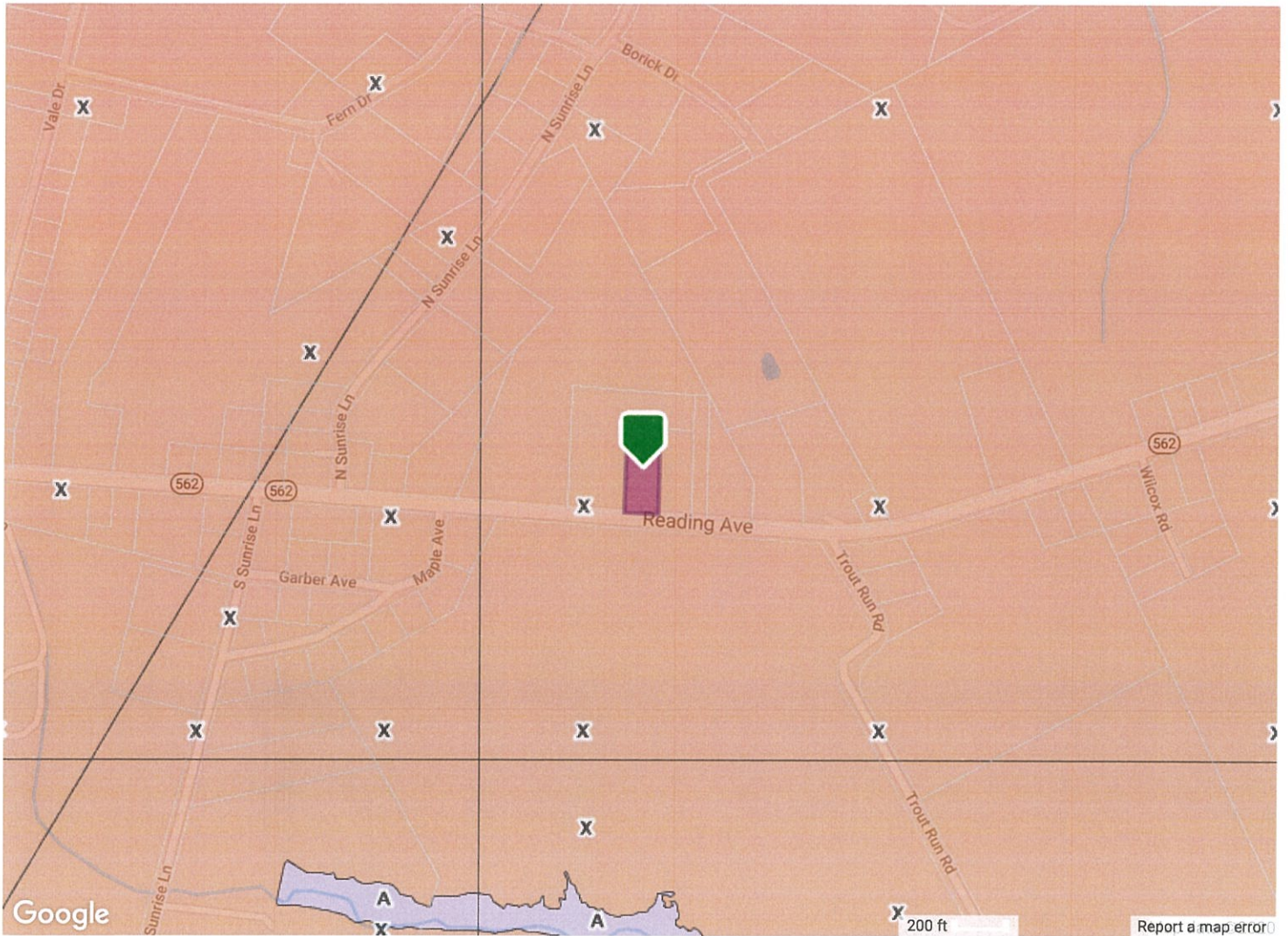

- Coastal 100-Year Floodway
- Coastal 100-year Floodplain
- 100-year Floodway
- 100-year Floodplain
- Undetermined
- 500-year Floodplain incl. levee protected area
- Out of Special Flood Hazard Area

The data on this report is compiled by BRIGHT from various public and private sources. The data on this is not a legal flood determination. Errors may exist in any field on this report, including owner's name, tax amounts, mortgage history, and property characteristics. Verify the accuracy of all data with the county or municipality.

© BRIGHT MLS - All information, regardless of source, should be verified by personal inspection by and/or with the appropriate professional(s). The information is not guaranteed. Measurements are solely for the purpose of marketing, may not be exact, and should not be relied upon for loan, valuation, or other purposes. Copyright 2020. Created: 11/02/2020 03:01 PM