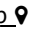

FIRST NAT'L BANK POINSETT CO

REGIONS BANK

TRUMANN, AR 72472

[Basic](#)[Land](#)[Sales](#)[Valuation](#)[Taxes](#)[Receipts](#)[Improvements](#)[View Map](#) 

Basic Info

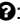
Parcel Number:	555-02309-0001
County Name:	Poinsett County
Property Address:	FIRST NAT'L BANK POINSETT CO REGIONS BANK TRUMANN, AR 72472
Mailing Address:	REGIONS BANK REGIONS PROPERTY DEPT 250 RIVERCHASE PARKWAY 6TH FLR BIRMINGHAM AL 35244
Billing Address  :	REGIONS BANK REGIONS PROPERTY DEPT 250 RIVERCHASE PARKWAY 6TH FLR BIRMINGHAM, AL 35244
Total Acres:	3.00
Timber Acres:	0.00
Sec-Twp-Rng:	11-12-05
Lot/Block:	/
Subdivision:	TRUMANN ACREAGE
Legal Description:	PART NE SW TRUMANN
School District:	21TM TRUMANN CITY
Improvement Districts:	ST FRANCIS LEVEE DIST,DRAINAGE DISTRICT 7
Homestead Parcel?:	No
Tax Status:	Taxable
Over 65?:	No

FIRST NAT'L BANK POINSETT CO

REGIONS BANK
TRUMANN, AR 72472

[Basic](#)

[Land](#)

[Sales](#)

[Valuation](#)

[Taxes](#)

[Receipts](#)

[Improvements](#)

[View Map](#) 

Land Divisions

Land Type	Quantity	Front Width	Rear Width	Depth 1	Depth 2	Quarter
HWY463.8	43,560 sqft	208	337	510	510	
HWY463.8S	87,120 sqft					

FIRST NAT'L BANK POINSETT CO

REGIONS BANK
TRUMANN, AR 72472

[Basic](#)

[Land](#)

[Sales](#)

[Valuation](#)

[Taxes](#)

[Receipts](#)

[Improvements](#)

[View Map](#) 

Sales History

Date	Price	Grantor	Grantee	Book	Page	Deed Type
11/1/1985	75,000			132	238	
10/1/1985	75,000			132	137	

FIRST NAT'L BANK POINSETT CO

REGIONS BANK
TRUMANN, AR 72472

[Basic](#) [Land](#) [Sales](#) **[Valuation](#)** [Taxes](#) [Receipts](#) [Improvements](#) [View Map](#) 

Valuation Information

Entry	Appraised	Assessed
Land:	69,700	13,940
Improvements:	419,200	83,840
Total Value:	488,900	97,780
Taxable Value:		97,780
Millage:		0.0486
Estimated Taxes ⓘ:		\$4,752.11
Assessment Year:		2018

FIRST NAT'L BANK POINSETT CO

REGIONS BANK

TRUMANN, AR 72472

[Basic](#)[Land](#)[Sales](#)[Valuation](#)[Taxes](#)[Receipts](#)[Improvements](#)[View Map](#) 

Tax Information

Year	Book	Tax Owed	Tax Paid	Balance
2018	Current	\$5,006.31	\$0.00	\$5,006.31
2017	Current	\$5,006.31	-\$5,006.31	\$0.00
2016	Current	\$4,670.59	-\$4,670.59	\$0.00
2015	Current	\$4,670.59	-\$4,670.59	\$0.00
2014	Current	\$4,670.59	-\$4,670.59	\$0.00
2013	Current	\$4,414.55	-\$4,414.55	\$0.00
2012	Current	\$4,414.55	-\$4,414.55	\$0.00
2011	Current	\$6,120.49	-\$6,120.49	\$0.00
2010	Current	\$6,120.49	-\$6,120.49	\$0.00
2009	Current	\$5,819.11	-\$5,819.11	\$0.00
2008	Current	\$5,372.33	-\$5,372.33	\$0.00
2007	Current	\$4,661.98	-\$4,661.98	\$0.00
2006	Current	\$4,238.33	-\$4,238.33	\$0.00

FIRST NAT'L BANK POINSETT CO

REGIONS BANK

TRUMANN, AR 72472

[Basic](#)[Land](#)[Sales](#)[Valuation](#)[Taxes](#)[Receipts](#)[Improvements](#)[View Map](#) 

Receipts

Receipt #	Book	Tax Year	ReceiptDate	Cash Amt	Check Amt	Credit Amt	Total
4748	Current	2017	9/4/2018	\$0.00	\$5,006.31	\$0.00	\$5,006.31
4567	Current	2016	8/28/2017	\$0.00	\$4,670.59	\$0.00	\$4,670.59
5273	Current	2015	9/19/2016	\$0.00	\$4,670.59	\$0.00	\$4,670.59
3439	Current	2014	6/8/2015	\$0.00	\$4,670.59	\$0.00	\$4,670.59
4326	Current	2013	8/15/2014	\$0.00	\$4,414.55	\$0.00	\$4,414.55
3319	Current	2012	6/17/2013	\$0.00	\$4,414.55	\$0.00	\$4,414.55
5368	Current	2011	9/26/2012	\$0.00	\$6,120.49	\$0.00	\$6,120.49
3346	Current	2010	6/24/2011	\$0.00	\$6,120.49	\$0.00	\$6,120.49
3935	Current	2009	7/12/2010	\$0.00	\$7,430.38	\$0.00	\$7,430.38
1933	Current	2008	5/1/2009	\$0.00	\$6,983.60	\$0.00	\$6,983.60
4372	Current	2007	9/8/2008	\$0.00	\$7,680.22	\$0.00	\$7,680.22
9601	Current	2006	10/23/2007	\$0.00	\$4,575.19	\$0.00	\$4,575.19

FIRST NAT'L BANK POINSETT CO

REGIONS BANK TRUMANN, AR 72472

- [Basic](#)
- [Land](#)
- [Sales](#)
- [Valuation](#)
- [Taxes](#)
- [Receipts](#)
- [Improvements](#)
- [View Map 📍](#)

Commercial Improvements

Commercial Improvement #1

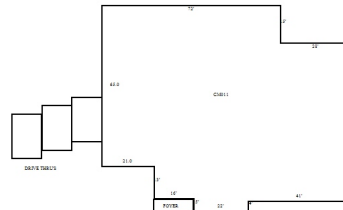

Sketch by Appen IV Windows™

Building Section #:	1		
Business Name:	FIRST NATIONAL BANK OF POINSETT		
Location:			
Total SF:	7,258		
Stories:	1		
Year Built:	1987		
Effective Age:	20		
Occupancy:	Code	Description	Class
	443	Central Bank	D-1
			100%

Additive Items:	Description	Qty.
	DRINKING FOUNTIAN	1
	RANGE TOP	1
	REFRIG	1
	Bank Equipment Drive Up Windows, each	1
	Bank Equipment Drive Up Windows, Remote V	2
	Bank Equipment Safe Deposit Boxes 5" x 5"	48
	Bank Equipment Safe Deposit Boxes 3" x 10"	42
	Bank Equipment Safe Deposit Boxes 5" x 10"	84
	Bank Equipment Safe Deposit Boxes 10" x 10"	40
	Bank Equipment Vault Doors, Class M (2-3")	1
	Bank Equipment, ATM Automatic Teller Machines	1
	Bank equipment, Safe Deposit Boxes Safe Deposit Boxes, 3 X 5	192
	Bank Equipment, Vault Doors Vault Doors, Circ., 12"	1
	Lighting Mercury vapor (ea.)	8
	Paving Concrete, 4" reinforced	28119
	SIGNS (2X12) Illum. Plastic single	24
	SIGNS (2X12) Illum. Plastic single	24
	Signs Illum. Plastic double	72
	Signs, Posts or Poles 12" diameter	14
	SIGNS, POSTS OR POLES 4@ 14 FT. EACH 6" diameter	56

Structural Elements:	Description	Qty.
	Ceilings Acoustic	X
	Electrical Average	X
	Exterior Walls Brick Veneer	X
	Floor Covering Carpet	X
	Floor Covering Computer Floor	X
	Floor Structure Elevated Slab	X
	Foundation Concrete	X
	Insulation Ceilings	X
	Insulation Walls	X
	Interior Finish Dry Wall	X
	Miscellaneous Doors, Plate Glass	X
	Miscellaneous Plate Glass	X
	Miscellaneous TV Security	X
	Plumbing Lavatory	X
	Plumbing Water Closet	X
	Roof Cover Tar & Gravel	X
	Roof Structure Wood Joists & Deck	X
	Site Work Preperation	X
	Structural Frame Wood	X