

FIRST STATE BANK OF FORDYCE

611 W 4TH ST
FORDYCE, AR 71742



[Basic](#) [Land](#) [Sales](#) [Valuation](#) [Taxes](#) [Receipts](#) [Improvements](#) [View Map](#)

Basic Info

Parcel Number:	801-01223-000
County Name:	Dallas County
Property Address:	FIRST STATE BANK OF FORDYCE 611 W 4TH ST FORDYCE, AR 71742 Map This Address
Mailing Address:	FIRST STATE BANK OF FORDYCE C/O REGIONS FINANCIAL CORP P O BOX 1448 MONTGOMERY AL 36102-1448
Collector's Mailing Address	REGIONS BANK * 250 RIVERCHASE PKWY E BIRMINGHAM, AL 35244
Total Acres:	1.95
Timber Acres:	0.00
Sec-Twp-Rng:	--
Lot/Block:	/
Subdivision:	CLYDE ADDITION
Legal Description:	E 200' OF N 250' of BLOCK 7 & W 135' OF N 258' OF LOT 1 BLK 8
School District:	I39 Fordyce
Homestead Parcel?:	No
Tax Status:	Taxable
Over 65?:	No

FIRST STATE BANK OF FORDYCE

611 W 4TH ST
FORDYCE, AR 71742



[Basic](#) [Land](#) [Sales](#) [Valuation](#) [Taxes](#) [Receipts](#) [Improvements](#) [View Map](#)

Land Divisions

Land Type	Quantity	Front Width	Rear Width	Depth 1	Depth 2	Quarter
COMM	1.15 acres [50,000 sqft]	200	200	250	250	
RESHS	0.80 acres [34,830 sqft]	135	135	258	258	

FIRST STATE BANK OF FORDYCE

611 W 4TH ST
FORDYCE, AR 71742



[Basic](#) [Land](#) [Sales](#) [Valuation](#) [Taxes](#) [Receipts](#) [Improvements](#) [View Map](#)

Sales History

Filed	Sold	Price	Grantor	Grantee	Book	Page	Deed Type
1/1/1995	1/1/1995	0	FIRST STATE BANK OF FORDYCE				

FIRST STATE BANK OF FORDYCE

611 W 4TH ST
FORDYCE, AR 71742

[Basic](#) [Land](#) [Sales](#) [Valuation](#) [Taxes](#) [Receipts](#) [Improvements](#) [View Map](#)

Valuation Information

Entry	Appraised	Assessed
Land:	116,600	23,320
Improvements:	783,350	156,670
Total Value:	899,950	179,990
Taxable Value:		179,990
Millage:		0.0452
Estimated Taxes ⓘ:		\$8,135.55
Assessment Year:		2019

FIRST STATE BANK OF FORDYCE

611 W 4TH ST
FORDYCE, AR 71742

[Basic](#) [Land](#) [Sales](#) [Valuation](#) [Taxes](#) [Receipts](#) [Improvements](#) [View Map](#)

Tax Information

Year	Book	Tax Owed	Tax Paid	Balance
2018	Current	\$8,063.68	-\$8,063.68	\$0.00
2017	Current	\$8,063.68	-\$8,063.68	\$0.00
2016	Current	\$8,063.68	-\$8,063.68	\$0.00
2015	Current	\$8,063.68	-\$8,063.68	\$0.00
2014	Current	\$8,063.68	-\$8,063.68	\$0.00
2013	Current	\$8,068.20	-\$8,068.20	\$0.00
2012	Current	\$8,068.20	-\$8,068.20	\$0.00
2011	Current	\$8,068.20	-\$8,068.20	\$0.00
2010	Current	\$8,068.20	-\$8,068.20	\$0.00
2009	Current	\$8,068.20	-\$8,068.20	\$0.00
2008	Current	\$8,079.50	-\$8,079.50	\$0.00
2007	Current	\$8,079.50	-\$8,079.50	\$0.00

FIRST STATE BANK OF FORDYCE

611 W 4TH ST
FORDYCE, AR 71742

[Basic](#) [Land](#) [Sales](#) [Valuation](#) [Taxes](#) [Receipts](#) [Improvements](#) [View Map](#)

Receipts

Receipt #	Book	Tax Year	ReceiptDate	Cash Amt	Check Amt	Credit Amt	Total
2175	Current	2018	9/19/2019	\$0.00	\$8,063.68	\$0.00	\$8,063.68
1866	Current	2017	8/29/2018	\$0.00	\$8,063.68	\$0.00	\$8,063.68
2018	Current	2016	9/11/2017	\$0.00	\$8,063.68	\$0.00	\$8,063.68
1968	Current	2015	9/19/2016	\$0.00	\$8,063.68	\$0.00	\$8,063.68
1350	Current	2014	6/8/2015	\$0.00	\$8,063.68	\$0.00	\$8,063.68
1669	Current	2013	8/18/2014	\$0.00	\$8,068.20	\$0.00	\$8,068.20
1410	Current	2012	6/13/2013	\$0.00	\$8,068.20	\$0.00	\$8,068.20
2137	Current	2011	9/26/2012	\$0.00	\$9,014.69	\$0.00	\$9,014.69
1400	Current	2010	6/24/2011	\$0.00	\$8,068.20	\$0.00	\$8,068.20
1462	Current	2009	7/12/2010	\$0.00	\$8,068.20	\$0.00	\$8,068.20
1180	Current	2008	5/1/2009	\$0.00	\$8,598.85	\$0.00	\$8,598.85
1852	Current	2007	9/8/2008	\$0.00	\$8,079.50	\$0.00	\$8,079.50

FIRST STATE BANK OF FORDYCE

611 W 4TH ST
 FORDYCE, AR 71742

- [Basic](#)
- [Land](#)
- [Sales](#)
- [Valuation](#)
- [Taxes](#)
- [Receipts](#)
- [Improvements](#)
- [View Map](#)

Commercial Improvements

Commercial Improvement #1

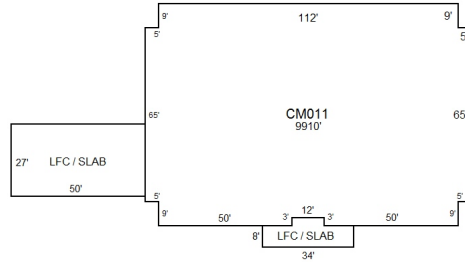

Sketch by Apan IV Windows™

Building Section #:	1			
Business Name:	REGIONS BANK			
Location:	611 W 4TH ST			
Total SF:	9,910			
Stories:	1			
Year Built:	1994			
Effective Age:	23			
Occupancy:	Code	Description	Class	Percent
	304	Bank	C-2	100%

Additive Items:

Description	Qty.
Bank Equipment ATM	1
Bank Equipment Drive Up Windows, Remote V	3
Bank Equipment Safe Deposit Boxes 3" x 5"	278
Bank Equipment Safe Deposit Boxes 3" x 10"	70
Bank Equipment SAFE DEPOSIT BOXES 4" X 10"	5
Bank Equipment Safe Deposit Boxes 10" x 10"	23
Bank Equipment Vault Doors, Class 3 (10")	1
CANOPIES COM W/BLDG	308
Canopies Wood, including built up, comp	1350
FLAT WOOD PRIVACY FENCE/NCV	1
FLAT/NCV PARKING STRIPE & BUMPERS	1
Lighting Mercury vapor (ea.)	5
Lighting POLES PER FOOT OF HEIGHT 5 20' POLES	100
Paving Concrete, 4" reinforced	37688
Signs ILLUM. PLASTIC DOUBLE 10*16	160
Signs METAL, PAINTED SINGLE FACE 1*4	4
SIGNS SIGN LETTERS - NCV	11
Signs, Posts or Poles 12" diameter	14

Structural Elements:

Description	Qty.
Ceilings Acoustic	X
Electrical Average	X
Electrical Quality	
Exterior Walls Brick Veneer	X
Exterior Walls Load Bearing	X
Floor Covering Carpet	X
Floor Covering Computer Floor	X
Floor Structure Elevated Slab	X
Foundation Concrete	X
Insulation Ceilings	X
Insulation Walls	X
Interior Finish Dry Wall	X
Miscellaneous Gutters	X
Miscellaneous Kitchen	X
Miscellaneous TV Security	X
Plumbing Bathtub	
Plumbing Drinking Fountain	X
Plumbing Lavatory	X
Plumbing None	
Plumbing Shower	
Plumbing Sink	
Plumbing Solar Hot Water	
Plumbing Urinal	
Plumbing Water Closet	X
Plumbing Water Heater	
Roof Cover Composition Shingle	X
Roof Cover Tar & Gravel	X
Roof Structure Conc Joist & Slab	X
Roof Structure Slope	
Roof Structure Wood Joists & Deck	X
Site Work Excavation	X
Site Work Preperation	X
Structural Frame Wood	X

