

MANUFACTURED HOME
APPROX. LOCATION

NOV OR FORMERLY
EUGENE GRAHAM
PROBATE 461-248

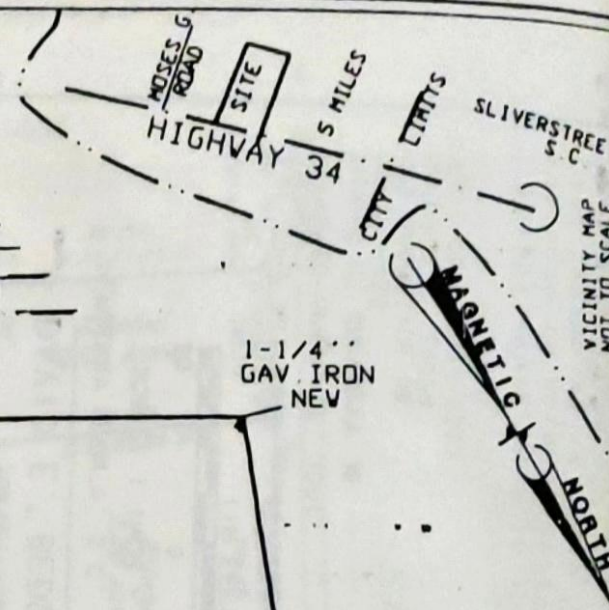

1-1/4" GAV. IRON NEV

N 58°12'12" V
256.00'

1-1/4" GAV. IRON NEV

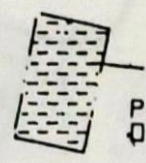

PROPOSED LOCATION ON MANUFACTURED HOME

NOV OR FORMERLY
PARCEL 'A'
PROBATE 461-248

DENNIS GRAHAM

S 22°56'18" V
345.00' TOTAL

2.00 ACRE

N 22°56'18" E
345.00' TOTAL

NOV OR FORMERLY
EUGENE GRAHAM
PROBATE 461-248

FILED, RECORDED, INDEXED
09/17/2001 09:50:33AM
Rec Fee: 5.00 St Fee: 0.00
Co Fee: 0.00 Pages: 1
Clerk of Court
Jackie S. Bowers

NOTE: THIS DISTANCE DID NOT MATCH REF. PLAT

303' +/- TO PROPERTY LINE

9.00'

CAPPED REBAR IRON OLD

1-1/4" GAV. IRON NEV

9.00'

C.P.

256.00'

S 58°12'12" E

C.P.

33.20'

249' +/- TO CORNER
CORNER AT MOSES G. ROAD C.P.

S.C. HIGHWAY S 36 - 34