

**Summary**

**Parcel Number** M02 052  
**Location Address** 112 MAIN ST  
**Legal Description** NORTH PART OF LOT 2 BLOCK B  
(Note: Not to be used on legal documents)  
**Class** C3-Commercial  
(Note: This is for tax purposes only. Not to be used for zoning.)  
**Zoning**  
**Tax District** MCINTYRE (District 04)  
**Millage Rate** 40.16  
**Acres** 1.37  
**Neighborhood** N/A  
**Homestead Exemption** No (S0)  
**Landlot/District** 114 / 10  
**Water** No Water  
**Sewer** No Sewer  
**Electric** No Electricity  
**Gas** Tank Gas  
**Topography** Level  
**Drainage** Poor  
**Road Class** Interstate  
**Parcel Road Access** No Road



[View Map](#)

**Owner**

JIN HA INC  
 112 MAIN STREET  
 MC INTYRE, GA 31054

**Land**

Type	Description	Calculation Method	Square Footage	Frontage	Depth	Acres	Lots
Commercial	Comm McIntyre Ac	Acres	59,677	0	0	1.37	0

**Commercial Improvement Information**

**Description** Market-C-AVG  
**Value** \$48,031  
**Actual Year Built** 1969  
**Effective Year Built** 1974  
**Square Feet** 3376  
**Wall Height** 8  
**Wall Frames**  
**Exterior Wall**  
**Roof Cover**  
**Interior Walls**  
**Floor Construction**  
**Floor Finish**  
**Ceiling Finish**  
**Lighting**  
**Heating**  
**Number of Buildings** 1

**Description** Market-C-AVG  
**Value** \$30,146  
**Actual Year Built** 2008  
**Effective Year Built** 2008  
**Square Feet** 780  
**Wall Height** 12  
**Wall Frames**  
**Exterior Wall**  
**Roof Cover**  
**Interior Walls**  
**Floor Construction**  
**Floor Finish**  
**Ceiling Finish**  
**Lighting**  
**Heating**  
**Number of Buildings** 1

## Sales

Sale Date	Deed Book / Page	Plat Book / Page	Sale Price	Reason	Grantor	Grantee
3/19/2015	362 225	135	\$170,000	OTHER	LEE JAE YUN	JIN HA INC
6/6/2002	269 638	135	\$185,000	OTHER	NELSON SHANNON	LEE JAE YUN
12/31/1999	250 357	135	\$162,000	NOT FMV	DUNN'S GROCERY	NELSON SHANNON

## Valuation

	2018	2017	2016	2015
Previous Value	\$86,397	\$86,397	\$69,647	\$69,647
Land Value	\$8,220	\$8,220	\$8,220	\$8,220
+ Improvement Value	\$78,177	\$78,177	\$78,177	\$61,427
+ Accessory Value	\$0	\$0	\$0	\$0
= Current Value	\$86,397	\$86,397	\$86,397	\$69,647

## Photos



## Sketches

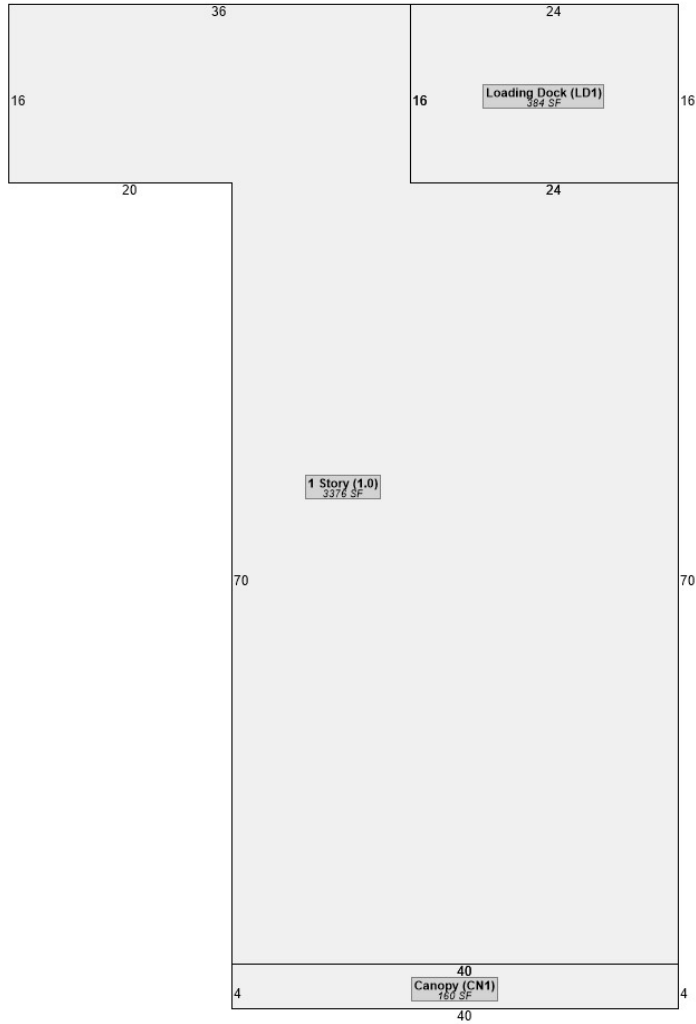

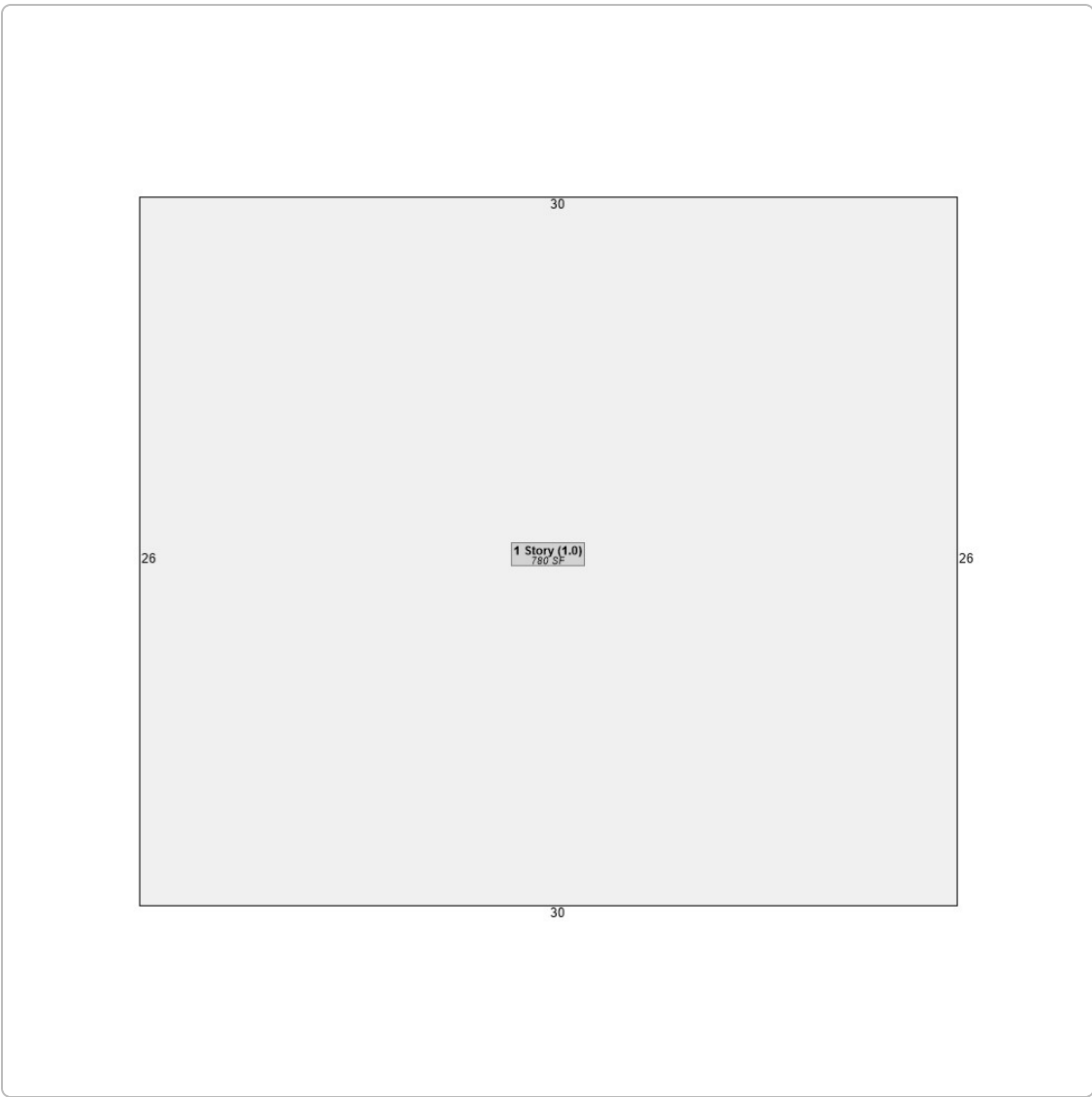

**No data available for the following modules:** Rural Land, Conservation Use Rural Land, Residential Improvement Information, Mobile Homes, Accessory Information, Prebill Mobile Homes, Permits.

The Wilkinson County Assessor makes every effort to produce the most accurate information possible. No warranties, expressed or implied are provided for the data herein, its use or interpretation. The assessment information is from the last certified tax roll. All other data is subject to change.

Developed by  
 Schneider  
GEOSPATIAL

Last Data Upload: 3/11/2019 7:02:37 AM

Version 2.2.4