

REAL ESTATE AUCTION

Prime Restaurant / Bar in the Heart of Fort Lauderdale

301-307 SW 2nd Street, Fort Lauderdale, Florida 33312



Exclusively Presented By:



**Live On-Site Auction:
Wednesday, June 5 @ 11 AM**



Table of Contents

Executive Summary	3
Site Plan / Location Maps	7
Photographs	12

DISCLAIMER AND CONFIDENTIALITY

THIS AUCTION PROPERTY PACKAGE HAS BEEN PREPARED SOLELY FOR INFORMATION PURPOSES TO ASSIST A POTENTIAL BIDDER IN DETERMINING WHETHER IT WISHES TO PROCEED WITH AN IN-DEPTH INVESTIGATION OF THE PROPERTY. THE SELLER AND ITS AGENTS, FISHER AUCTION COMPANY AND EXP REALTY, SPECIFICALLY DISCLAIM ANY REPRESENTATION OR WARRANTY, EXPRESS OR IMPLIED, AS TO THE ACCURACY OR COMPLETENESS OF THIS PROPERTY INFORMATION PACKAGE OR OF ANY OF ITS CONTENTS. ALL FINANCIAL INFORMATION IS PROVIDED FOR GENERAL REFERENCE PURPOSES ONLY. THE PROPERTY IS BEING SOLD IN "AS IS," "WHERE IS" CONDITION AS OF THE DATE OF THE CLOSING THEREON. THE SELLER WILL MAKE NO AGREEMENT TO ALTER, REPAIR OR IMPROVE THE PROPERTY. THE SELLER, ITS AGENTS, FISHER AUCTION COMPANY AND EXP REALTY DISCLAIM ANY WARRANTY, GUARANTY OR REPRESENTATION, ORAL OR WRITTEN, PAST OR PRESENT, EXPRESS OR IMPLIED CONCERNING THE PROPERTY DISCUSSED IN THIS PROPERTY INFORMATION PACKAGE. THE SELLER, ITS AGENTS, FISHER AUCTION COMPANY AND EXP REALTY HAVE ONLY LIMITED KNOWLEDGE OF THE CONDITION OF THE PROPERTY. THE PURCHASE OF THE PROPERTY WILL BE BASED SOLELY ON A BUYER'S OWN INDEPENDENT INVESTIGATION AND FINDINGS AND NOT IN RELIANCE ON ANY INFORMATION PROVIDED BY THE SELLER, ITS AGENTS, FISHER AUCTION COMPANY AND EXP REALTY.

**Lead Broker:
Kevin Berman
954.471.8120**

Kevin.berman@exprealty.com

Real Estate Auction Consultant:

**Francis D. Santos
954.931.0644**

francis@fisherauction.com

EXECUTIVE SUMMARY



OVERVIEW

Fisher Auction Company and EXP Realty are pleased to present via Live Real Estate Auction an 11,500± Square Foot Prime Restaurant / Bar in the Heart of Downtown Fort Lauderdale, Florida

Property Highlights

- Newly Constructed State-of-the -Art Free Standing Building with 11,500± Square Feet Total Area on a Large .41± Acre Corner Lot
- Prime Location in the Heart of the Riverwalk Area in Downtown Fort Lauderdale
- Within the Special Entertainment Open Container District with a 4 AM Liquor License
- Frontage includes 152± Feet along SW 2nd Street and 130± Feet along SW 3rd Avenue
- Just East of the Museum of Discovery and Science and the Broward Performing Arts Center
- Buildout includes 6 Interior/Exterior Bar Areas with a maximum of 556 Patrons and 216 Seating
- Fully Equipped Restaurant / Nightclub with Elevated Stage perfect for Headliner Live Entertainment
- 14 On-Site Parking Spaces with Perpetual Easement Agreement to adjacent Parking Lot Area with 100+ Spaces
- Close Proximity to Major Commercial, Retail and Residential Redevelopment and Brightline Station
- Second Floor VIP Bars and Banquet Area with Manager's Office and Green Room with Private Bathroom and Shower

Disclaimer; the information above has been obtained from sources deemed reliable. While we do not doubt the accuracy, we have not verified it and make no guarantee, warranty or representation about it. Any projections, opinions, assumptions or estimates used are for example only and do not present the current or future performance of the property. It is your responsibility to independently verify the accuracy and completeness of the information.

Construction Details / Features

- CBS Construction / Built in 2018
- Barrel Tile Roof
- Impact Resistant Windows and Doors
- Full Commercial Kitchen w/ Walk-In Cooler and Freezer
- Tile Flooring
- Commercial Elevator
- HVAC – 5 Central, Multi-Zoned Units
- Fire Alarm / Sprinklers
- High Tech Video Security System
- Bathrooms – 1st Floor- 2 Men's, 2 Women's / Second Floor- 2 Men's, 2 Women's
- Glycol Cooling System for Draft Lines includes 16 Taps at Main Bar and 8 at each Satellite Bar
- Walk-In Cooler at Main Bar
- 3 Big Screen Television Sets
- Handicap Wheel Chair Lift – Building is ADA Compliant
- State-of-the-Art Sound System and LED Lighting
- 2 Commercial 2,400 Pound Ice Machines
- 12 Custom Built Natural Gas Lanterns
- 3 DJ Sound/Lighting Booths
- Custom Ceiling Fans
- Wi-Fi Throughout
- Fully Furnished and Supplied Operating Restaurant/Bar/Entertainment Business
- Fully Customized Building designed by Steve Edwards AIA and Built by RCC Associates
- 2 Security Safe's
- On-Site Commercial Trash Compactor

Disclaimer; the information above has been obtained from sources deemed reliable. While we do not doubt the accuracy, we have not verified it and make no guarantee, warranty or representation about it. Any projections, opinions, assumptions or estimates used are for example only and do not present the current or future performance of the property. It is your responsibility to independently verify the accuracy and completeness of the information.

EXECUTIVE SUMMARY

PROPERTY DETAILS

Address: 301-307 SW 2nd Street, Fort Lauderdale, Florida 33312

Building Size: 11,500± Total SF / 8,477± SF Interior

Lot Size: 17,942± SF / .41± Acres

Access: SW 2nd Street and SW 3rd Avenue

Zoning: H-1 / RAC-AS

Utilities: Municipal Water and Sewer

2019 Taxes: TBD

Folio: 5042-10-01-2260

Legal Description: FT LAUDERDALE B-40 D LOT 13 & 14, TOGETHER WITH LOT 15 LESS THE N 18 FEET OF THE WEST 95 FEET OF SAID LOT 15, TOGETHER WITH THE E1/2 OF THE VAC'D ALLEY LYING WEST AND ADJACENT TO SAID LOTS 13, 14 AND PORTION OF 15 BLK 17

Flood Zone: Zone AH- Per FEMA Panel No. 12011C0557H

Directions: From I-95 East on Broward Boulevard to SW 4th Avenue. Right to SW 2nd Street. Left to Address

AUCTION DETAILS

Auction Method:	\$6,600,000 Minimum Bid plus a 7% Buyer's Premium Recently Appraised for \$9,850,000 Pre Auction Offers Encouraged
Auction Date / Time:	Wednesday, June 5, 2019 @ 11:00 AM ET
Auction Location:	Onsite; 301 SW 2 nd Street, Fort Lauderdale, Florida 33312 Real Time Online Bidding Available
Qualifying Bidder Requirements:	<ul style="list-style-type: none"> ➤ Bidders must wire transfer the initial qualifying Escrow Deposit in the amount of \$100,000 in U.S. Funds to Les H Stevens P A Florida Bar Foundation IOTA Trust Account (Escrow Agent/Settlement Agent Name), no later than Monday, June 3 at 4 PM ET. ➤ An Additional Escrow Deposit ("Additional Escrow Deposit") equal to the difference between 10% of the Total Purchase Price and the Initial Escrow Deposit, is to be paid to Les H Stevens P A Florida Bar Foundation IOTA Trust Account (Escrow Agent/Settlement Agent), via wire transfer in U.S. Funds. Said wire transfer to be initiated by no later than 4:00 PM ET on Wednesday, June 5, 2019
Broker Participation:	2% of the Final Bid Price. Call 800.331.6620 or visit www.fisherauction.com for the Mandatory Real Estate Buyer Broker Participation Registration Form

Disclaimer; the information above has been obtained from sources deemed reliable. While we do not doubt the accuracy, we have not verified it and make no guarantee, warranty or representation about it. Any projections, opinions, assumptions or estimates used are for example only and do not present the current or future performance of the property. It is your responsibility to independently verify the accuracy and completeness of the information.

SITE PLAN / LOCATION MAPS



SITE PLAN

SITE DATA

ZONING:	H-1 (RAC-AS)	
PARKING:	13 STANDARD, SELF-PARK SPACES/ NONE REQUIRED	
SURVEY:	ALL SITE PLAN & LEGAL DESCRIPTION INFORMATION SHOWN IS FROM BOUNDARY SURVEY BY MCLAUGHLIN ENGINEERING, INC. FT. LAUDERDALE, FL. 13 JUNE 2016. FILE # 88-1-55(14) (SEE SURVEY FOR LEGAL DESCRIPTION)	
SITE AREA:	17,924 S.F. (0.4115 ACRES)	
BUILDING AREAS:	1ST FLOOR INTERIOR: 5,748 S.F.	
	HISTORIC BUILDING: 324 S.F.	
	TOTAL: 6,072 S.F.	
	STORAGE BUILDING: 336 S.F.	
	1ST FLOOR EXTERIOR TERRACE: 1,622 S.F.	
	TOTAL: 8,030 S.F.	
	2ND FLOOR INTERIOR: 2,069 S.F.	
	2ND FLOOR DECK: 1,360 S.F.	
SITE BREAKDOWN:	TOTAL BUILDING FOOTPRINT: 8,030 S.F.	
	PARKING AREA: 6,543 S.F.	
	LANDSCAPE & HARDSCAPE AREAS: 3,349 S.F.	
	TOTAL: 17,922 S.F.	
SET BACKS:	STANDARD	PROVIDED
FRONT (SOUTH):	0'	0'
REAR (NORTH):	0'	44'-6"
SIDE STREET (EAST):	0'	0'
SIDE INTERIOR (WEST):	0'	20'-3"
BUILDING HT.:	25' (MAX.)	25' (2 STORY BUILDING)

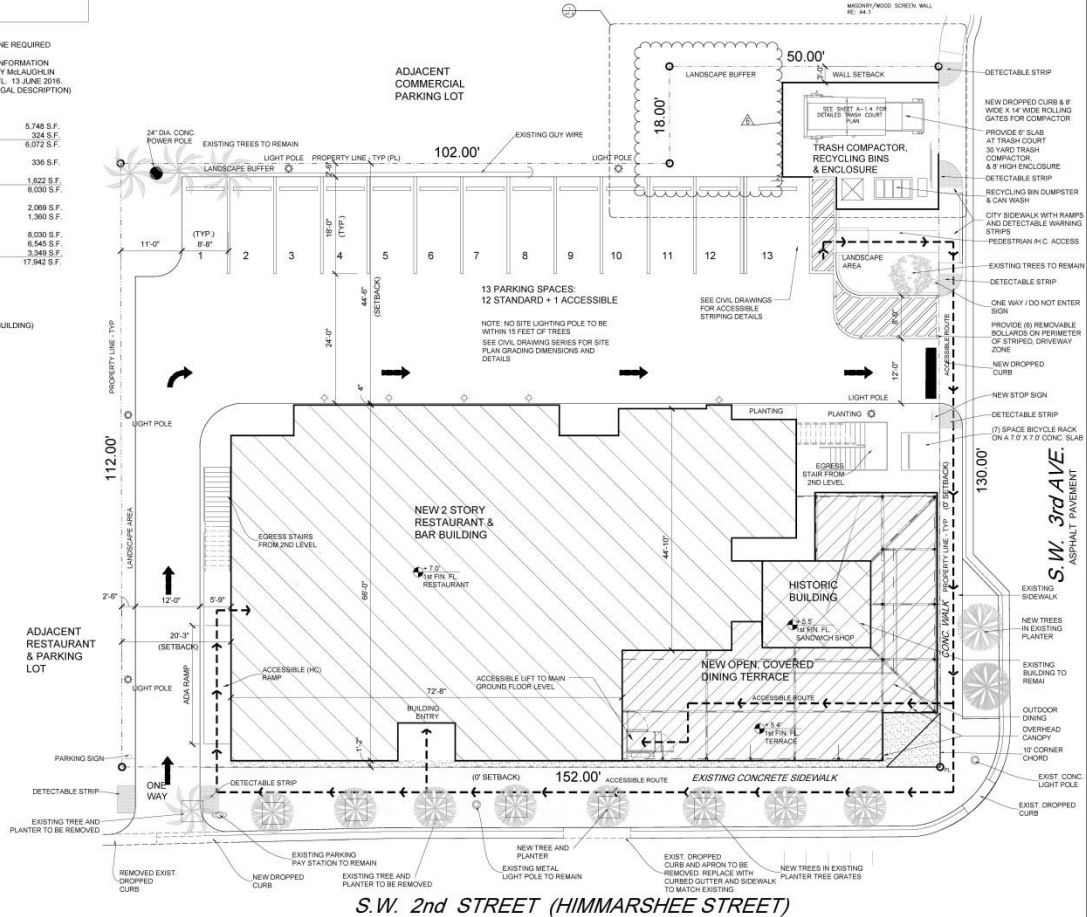

SITE PLAN

1/8"=1'

SEA
Steve Edwards Architectural LLC
1001 S.W. 14th Terrace
Davie, FL 33317
Phone: 954.278.1111
Fax: 954.278.1112

SEA
Steve Edwards Architectural LLC
1001 S.W. 14th Terrace
Davie, FL 33317
Phone: 954.278.1111
Fax: 954.278.1112

SEA
Steve Edwards Architectural LLC
1001 S.W. 14th Terrace
Davie, FL 33317
Phone: 954.278.1111
Fax: 954.278.1112

SEA
Steve Edwards Architectural LLC
1001 S.W. 14th Terrace
Davie, FL 33317
Phone: 954.278.1111
Fax: 954.278.1112

SEA
Steve Edwards Architectural LLC
1001 S.W. 14th Terrace
Davie, FL 33317
Phone: 954.278.1111
Fax: 954.278.1112

SEA
Steve Edwards Architectural LLC
1001 S.W. 14th Terrace
Davie, FL 33317
Phone: 954.278.1111
Fax: 954.278.1112

SEA
Steve Edwards Architectural LLC
1001 S.W. 14th Terrace
Davie, FL 33317
Phone: 954.278.1111
Fax: 954.278.1112

SEA
Steve Edwards Architectural LLC
1001 S.W. 14th Terrace
Davie, FL 33317
Phone: 954.278.1111
Fax: 954.278.1112

SEA
Steve Edwards Architectural LLC
1001 S.W. 14th Terrace
Davie, FL 33317
Phone: 954.278.1111
Fax: 954.278.1112

SEA
Steve Edwards Architectural LLC
1001 S.W. 14th Terrace
Davie, FL 33317
Phone: 954.278.1111
Fax: 954.278.1112

SEA
Steve Edwards Architectural LLC
1001 S.W. 14th Terrace
Davie, FL 33317
Phone: 954.278.1111
Fax: 954.278.1112

Construction Documents VE Revision for Permit # 15063636

Site Plan #00 Restaurant and Bar

Diane & Eric Magid
City Centre Properties
291-301 S.W. 2nd Street
FT. LAUDERDALE, FL 33301

A-1.0

Disclaimer: the information above has been obtained from sources deemed reliable. While we do not doubt the accuracy, we have not verified it and make no guarantee, warranty or representation about it. Any projections, opinions, assumptions or estimates used are for example only and do not present the current or future performance of the property. It is your responsibility to independently verify the accuracy and completeness of the information.

LOCATION MAPS

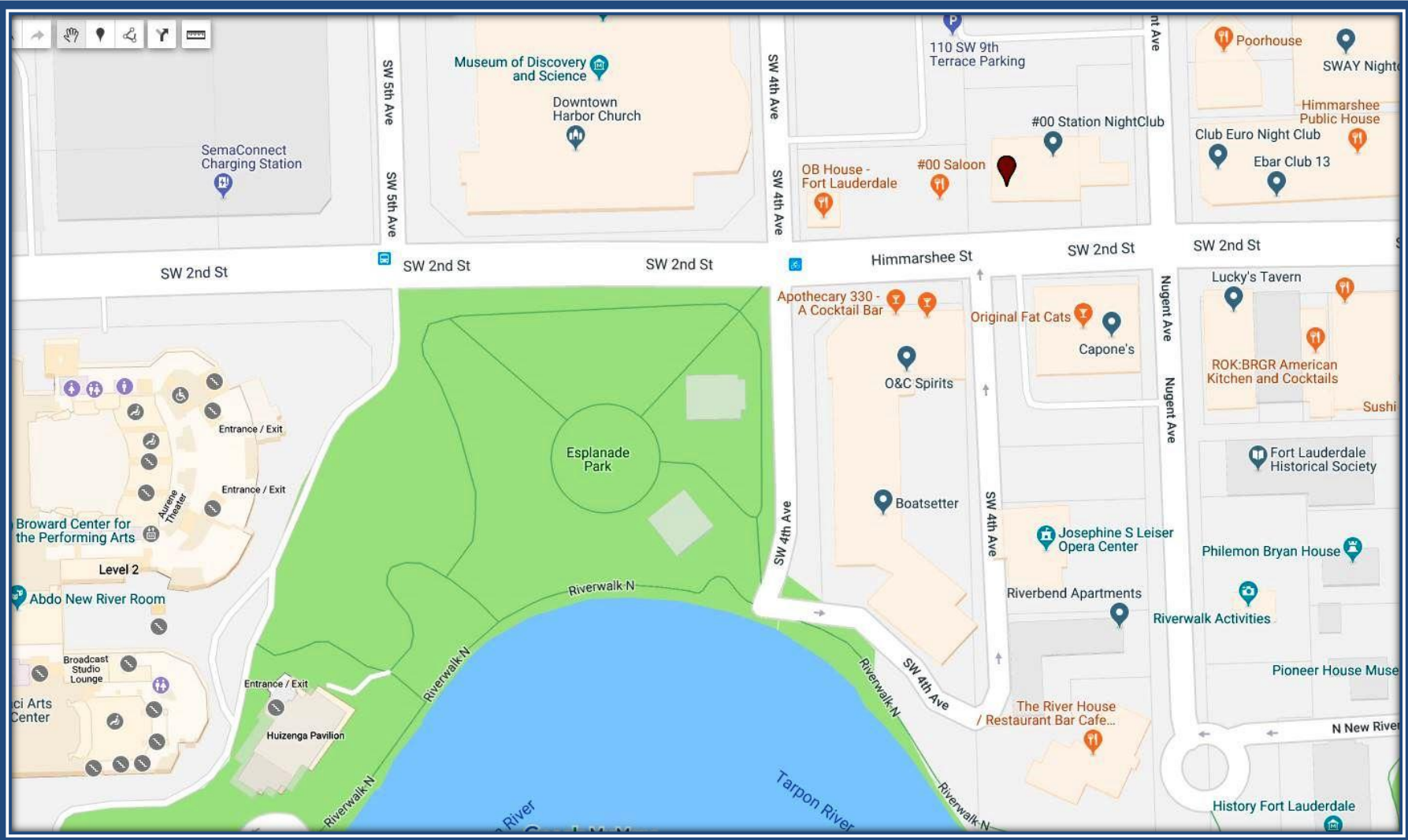

Disclaimer: the information above has been obtained from sources deemed reliable. While we do not doubt the accuracy, we have not verified it and make no guarantee, warranty or representation about it. Any projections, opinions, assumptions or estimates used are for example only and do not present the current or future performance of the property. It is your responsibility to independently verify the accuracy and completeness of the information.

LOCATION MAPS

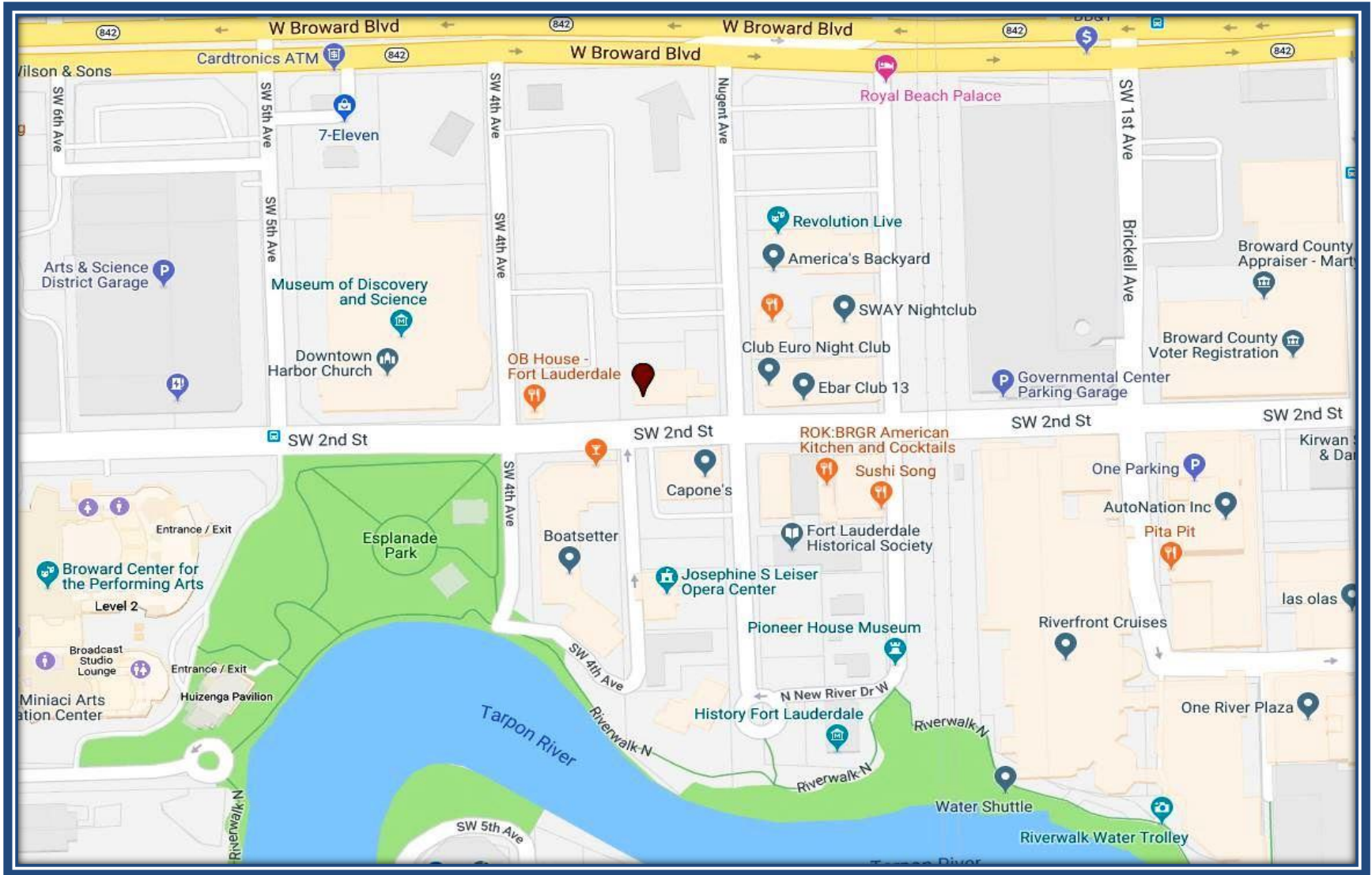

Disclaimer: the information above has been obtained from sources deemed reliable. While we do not doubt the accuracy, we have not verified it and make no guarantee, warranty or representation about it. Any projections, opinions, assumptions or estimates used are for example only and do not present the current or future performance of the property. It is your responsibility to independently verify the accuracy and completeness of the information.

LOCATION MAPS

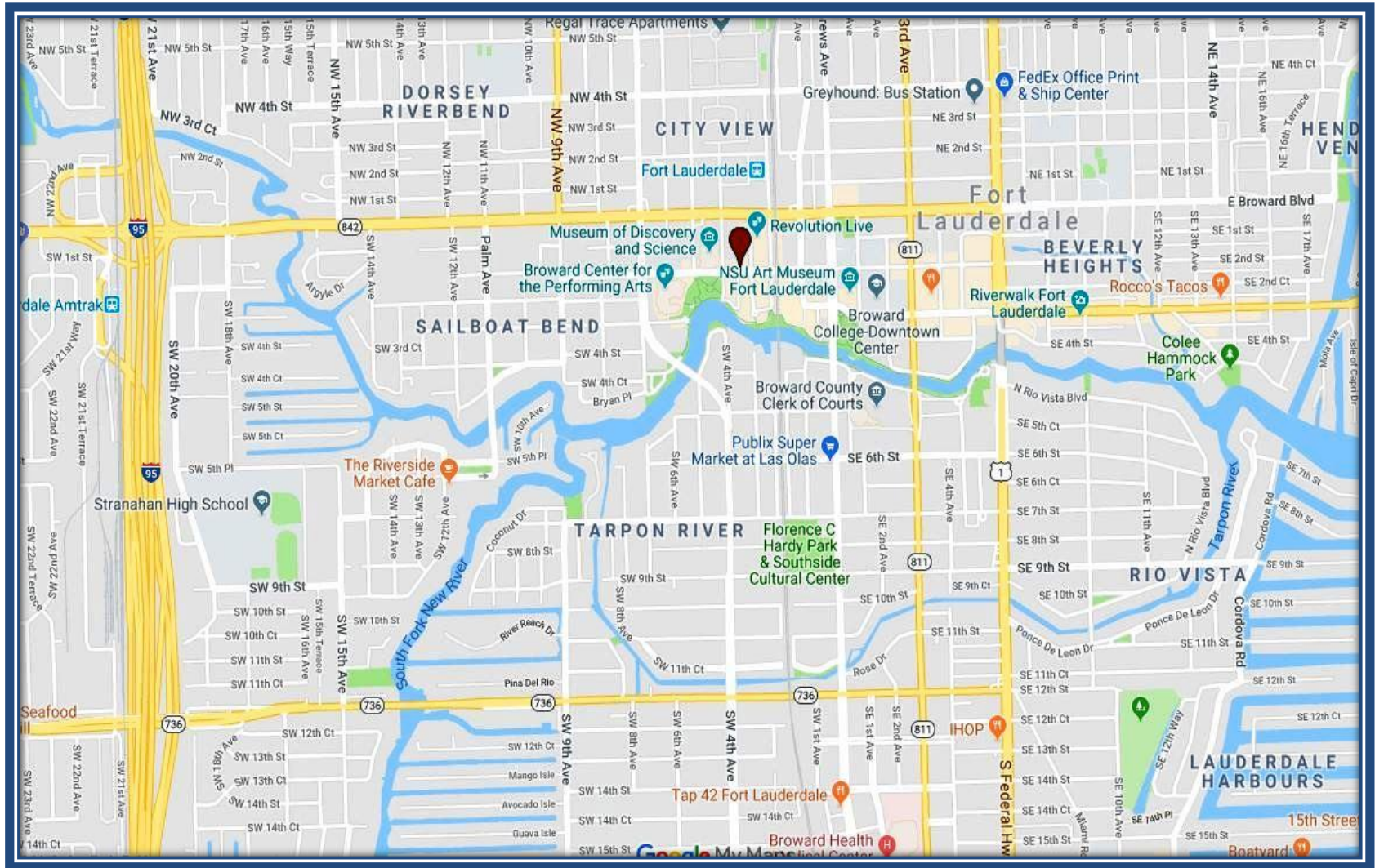

Disclaimer: the information above has been obtained from sources deemed reliable. While we do not doubt the accuracy, we have not verified it and make no guarantee, warranty or representation about it. Any projections, opinions, assumptions or estimates used are for example only and do not present the current or future performance of the property. It is your responsibility to independently verify the accuracy and completeness of the information.

PHOTOGRAPHS











For additional information:

Francis D. Santos
754.220.4116
francis@fisherauction.com

Kevin Berman
954.471.8120
kevin.berman@exprealty.com

