

# Land For Sale

**ACREAGE:**

**155.48 Acres, m/l**

**LOCATION:**

**Bremer County, IA**



## Property Key Features

- Located on a Hard-Surface Road
- CSR2 of 84.71 on 151.82 Tillable Acres
- Nearly 100% Tillable

**Lawain Biermann, AFM**  
Licensed Salesperson in IA, MN  
**LawainB@Hertz.ag**

**319.234.1949**  
6314 Chancellor Dr. / P.O. Box 1105  
Cedar Falls, IA 50613  
**www.Hertz.ag**

**Troy Louwagie**  
Licensed Broker in IA, IL  
**TroyL@Hertz.ag**



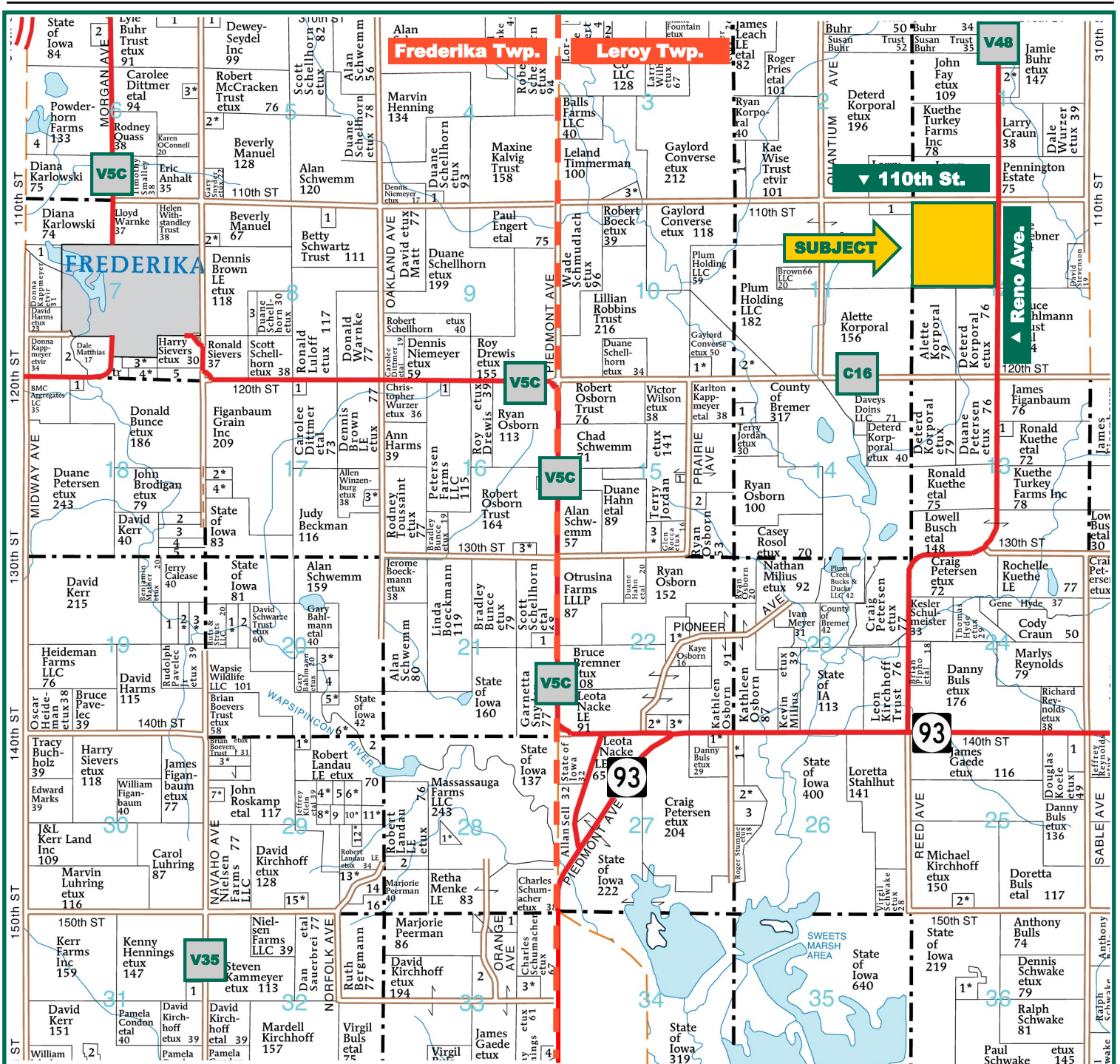

Map reproduced with permission of Farm & Home Publishers, Ltd.

**Lawain Biermann, AFM**  
Licensed Salesperson in IA, MN  
[LawainB@Hertz.ag](mailto:LawainB@Hertz.ag)

**319.234.1949**  
6314 Chancellor Dr. / P.O. Box 1105  
Cedar Falls, IA 50613  
[www.Hertz.ag](http://www.Hertz.ag)

**Troy Louwagie**  
Licensed Broker in IA, IL  
[TroyL@Hertz.ag](mailto:TroyL@Hertz.ag)



|                             |                   |
|-----------------------------|-------------------|
| <b>FSA/Eff. Crop Acres:</b> | <b>151.82</b>     |
| <b>Corn Base Acres:</b>     | <b>96.50</b>      |
| <b>Bean Base Acres:</b>     | <b>55.30</b>      |
| <b>Soil Productivity:</b>   | <b>84.71 CSR2</b> |

## Property Information

**155.48 Acres, m/l**

### Location

Approximately 4.5 miles east of Frederika, IA or approximately 5 miles south of Fredericksburg, IA

### Legal Description

NW 1/4 Section 12, Township 93 North, Range 12 West of the 5th P.M.

### Price & Terms

- \$1,536,600.00
- \$9,882.94/acre
- 10% down upon acceptance of offer; balance due in cash at closing

### Possession

Negotiable.

### Real Estate Tax

Taxes Payable 2019 - 2020: \$4,304.00  
Net Taxable Acres: 155.48  
Tax per Net Taxable Acre: \$27.68

### FSA Data

Farm Number 982, Tract 1524  
FSA/Eff. Crop Acres: 151.82  
Corn Base Acres: 96.50  
Corn PLC Yield: 145 Bu.  
Bean Base Acres: 55.30  
Bean PLC Yield: 44 Bu.

### Soil Types/Productivity

Primary soils are Readlyn silt loam and Tripoli clay loam. CSR2 on the FSA/Eff. crop acres is 84.71. See soil map for detail.

### Land Description

Level to gently rolling.

### Buildings/Improvements

None.

### Water & Well Information

None known.

### Comments

Well-maintained farm located on a hard-surface road with a CSR2 rating of 84.71 on 151.82 tillable acres.

**Lawain Biermann, AFM**  
Licensed Salesperson in IA, MN  
[LawainB@Hertz.ag](mailto:LawainB@Hertz.ag)

**319.234.1949**  
6314 Chancellor Dr. / P.O. Box 1105  
Cedar Falls, IA 50613  
[www.Hertz.ag](http://www.Hertz.ag)

**Troy Louwagie**  
Licensed Broker in IA, IL  
[TroyL@Hertz.ag](mailto:TroyL@Hertz.ag)





| Soil Label | Soil Name  | Acres | % of Field | NIRR Land Class | CSR2 |  |
|------------|--|-------|------------|-----------------|------|--|
| 399        | Readlyn silt loam, 1 to 3 percent slopes         | 96.60 | 63.63      | 1               | 91   |  |
| 398        | Tripoli clay loam, 0 to 2 percent slopes         | 18.12 | 11.93      | 2               | 82   |  |
| 198B       | Floyd loam, 1 to 4 percent slopes                | 10.67 | 7.03       | 2               | 89   |  |
| 471        | Oran loam, 1 to 3 percent slopes                 | 6.96  | 4.58       | 1               | 74   |  |
| 221        | Klossner muck, 1 to 4 percent slopes             | 6.64  | 4.37       | 3               | 48   |  |
| 175B       | Dickinson fine sandy loam, 2 to 5 percent slopes | 5.48  | 3.61       | 3               | 50   |  |
| 84         | Clyde silty clay loam, 0 to 3 percent slopes     | 4.91  | 3.23       | 2               | 88   |  |
| 41B        | Sparta loamy fine sand, 2 to 5 percent slopes    | 2.45  | 1.61       | 4               | 39   |  |

Measured Tillable Acres: 151.82

Average CSR2: 84.71

The information gathered for this brochure is from sources deemed reliable, but cannot be guaranteed by Hertz Real Estate Services, Inc. or its staff. All acres are considered more or less, unless otherwise stated. All property boundaries are approximate. Soil productivity ratings are based on the information currently available in the USDA/NRCS soil survey database. Those numbers are subject to change on an annual basis.

**Lawain Biermann, AFM**  
Licensed Salesperson in IA, MN  
[LawainB@Hertz.ag](mailto:LawainB@Hertz.ag)

**319.234.1949**  
6314 Chancellor Dr. / P.O. Box 1105  
Cedar Falls, IA 50613  
[www.Hertz.ag](http://www.Hertz.ag)

**Troy Louwagie**  
Licensed Broker in IA, IL  
[TroyL@Hertz.ag](mailto:TroyL@Hertz.ag)



**Lawain Biermann, AFM**  
Licensed Salesperson in IA, MN  
**LawainB@Hertz.ag**

**319.234.1949**  
6314 Chancellor Dr. / P.O. Box 1105  
Cedar Falls, IA 50613  
**www.Hertz.ag**

**Troy Louwagie**  
Licensed Broker in IA, IL  
**TroyL@Hertz.ag**



Looking west



Looking northwest



Looking west



Looking southeast

