

Pay Taxes

Property Information

Property ID	360-30004-0-0000	Property Use	100 - RESIDENTIAL
Tax Year	2019 <input type="button" value="v"/>	Land Use	113 - SINGLE FAMILY DWELLING
Township	360 Upper Leacock Twp	Tax Status	Taxable
Site Address	14 S HERSHEY AVE	Clean & Green	No

Property Sketches & Photos

1-1

Parcel photo

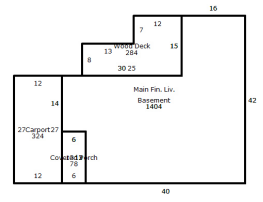

Related Names

Parcel Owner	ELLIOTT, A THOMAS C/O ROBIN E THOMAS 256 S HOMESTEAD DR LANDISVILLE, PA 17538	Deceased	THOMAS BETTIE M, C/O ROBIN E THOMAS 256 S HOMESTEAD DR LANDISVILLE, PA 17538
Status	Current	Status	Current

Assessments						
Annual Billing						
	Land	Building	Total	Pref. Land	Pref. Building	Pref. Total
Non-Exempt	43,400	129,200	172,600	0	0	0
Exempt	0	0	0	0	0	0
Total	43,400	129,200	172,600	0	0	0

Note: Preferential assessment values are used for taxation when preferential values are greater than zero.

Property Characteristics			
Electric	Gas	Sewage	Water
HOOKED-UP	NONE	PUBLIC SYSTEM	PUBLIC SYSTEM

Market Land Valuation			
Property Type	Land Type	Sq. Ft.	Calc. Acres
RES - Residential	2 - PRIMARY HOMESITE	7,841	0.1800

Structure 1 of 2

Property Type	Description	Style	Total Living Area	Year Built
RES - Residential	RANCH #1	One Story	1,404	1961

Accommodations	
Extra Fixtures	2
Full Baths	1
Number of Bedrooms	3
Number of Families	1
Number of Rooms	7

Basement	
Minimal Finish Area	494.00 Sq.Ft.
Total Basement Area	1404.00 Sq.Ft.

Exterior Walls	
Masonry, Common Brick	1404.00 Sq.Ft.

Fuel Type	
Fuel Type	Oil

Fireplaces	
Single 1-Story Fireplace	1.00 Units

Heating/Cooling	
Radiators, Hot Water	1404.00 Sq.Ft.

Garage/Carport	
Carport, Flat Roof	324.00 Sq.Ft.

Roofing	
Composition Shingle	1404.00 Sq.Ft.

Porches, Decks, Breezeways	
Slab Porch with Roof	78.00 Sq.Ft.
Wood Deck	284.00 Sq.Ft.

Story Height	
Number of Stories	1.00

Style	
Style	RANCH

Structure 2 of 2

Property Type	Description	Style	Total Living Area	Year Built
RES - Residential	Detached Structure #1	Outbuildings	600	1951

Garages

007 - Brick Garage	600.00 Square Ft.
--------------------	-------------------

Exemptions

Exemption Type	Status	Farmstead
Homestead	Appl Approved (Full)	No

Sales History

Year	Document #	Sale Type	Sale Date	Sold By	Sold To	Price
1900	Z-420067		1/1/1900			\$0

Billing

NOT A CERTIFIED COPY - FOR INFORMATIONAL PURPOSES ONLY

Billing Pd.	Tax Billed	Discount/Pen.	Total Billed	Total Paid	Balance Due	Date Paid
January	\$795.00	(\$15.90)	\$779.10	\$779.10	\$0.00	4/18/2019

Note: Payment amounts may only reflect the Lancaster County amounts

Tax Amounts - January

Fund Desc.	Rate Type	Tax Rate	2% Discount if paid by 4/30/2019	Base Tax if paid by 6/30/2019	10% Penalty if paid after 6/30/2019
Lancaster County	Millage	2.911000	\$492.39	\$502.44	\$552.68
Upper Leacock Twp	Millage	1.695000	\$286.71	\$292.56	\$321.82
Total			\$779.10	\$795.00	\$874.50

Contact Information

Please contact the following person or office with any questions regarding county collected current year taxes or for tax certification requests.

Lancaster County Treasurer
County & Municipal Tax Bill
P.O. Box 3894
LANCASTER, PA 17604
(717) 299-8222

Tax certification overnight requests can be sent to...

Lancaster County Treasurer
150 North Queen Street, Suite 122
Lancaster, PA 17603

Mail current year, county & municipal real estate tax payments to...

Lancaster County Treasurer
P.O. Box 3894
Lancaster, PA 17604

No Delinquent Taxes