

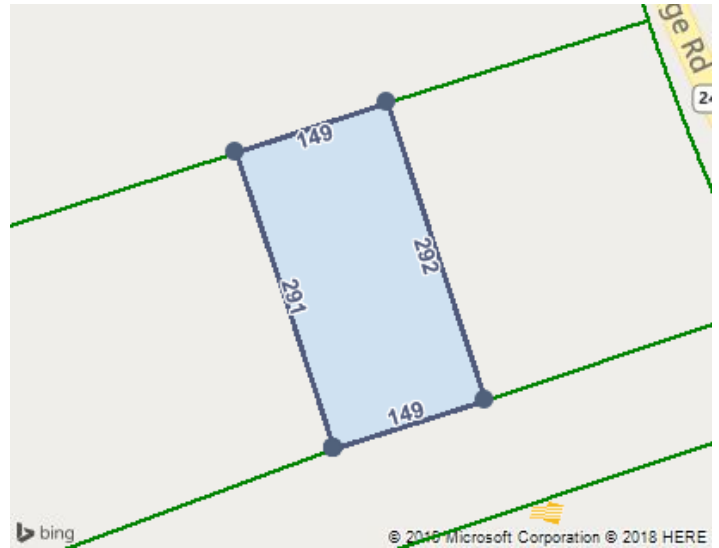

Friday, April 19, 2019



LOCATION

| | |
|-------------------------|------------------------|
| Property Address | Cooley Bridge Rd SC |
| Subdivision | |
| County | Greenville County, SC |

GENERAL PARCEL INFORMATION

| | |
|-----------------------------|-------------------|
| Parcel ID/Tax ID | 0605.04-01-017.00 |
| Alternate Parcel ID | |
| Account Number | |
| District/Ward | 1 |
| 2010 Census Trct/Blk | 32.01/2 |
| Assessor Roll Year | 2018 |

PROPERTY SUMMARY

| | |
|-------------------------|--------------------|
| Property Type | Residential |
| Land Use | Residential Vacant |
| Improvement Type | |
| Square Feet | |

CURRENT OWNER

| | |
|------------------------|---|
| Name | The Forfeited Land Commission |
| Mailing Address | 301 University Rdg Ste 600 Greenville, SC 29601-3665 |

SALES HISTORY THROUGH 04/03/2019

| Date | Amount | Buyer/Owners | Buyer/Owners 2 | Instrument | No. Parcels | Book/Page Or Document# |
|-----------|--------|-------------------------------|----------------|---------------|-------------|-------------------------|
| 2/19/2019 | | The Forfeited Land Commission | | Tax Sale Deed | | 2560/1885 2019015890 |
| 2/18/2014 | \$879 | Shiloh Investment Group LLC | | | | 2439/1938 |
| 5/22/1967 | | Jenkins Bessie E | | | | 822/273 |

TAX ASSESSMENT

| Appraisal | Amount | Assessment | Amount |
|-------------------------------|---------|------------------------------|--------|
| Appraisal Year | 2018 | Assessment Year | 2018 |
| Appraised Land | \$9,500 | Assessed Land | \$570 |
| Appraised Improvements | | Assessed Improvements | |
| Total Tax Appraisal | \$9,500 | Total Assessment | \$570 |
| Assessment Rate | 6.00% | Exempt Amount | |

Exempt Reason

TAXES

| Tax Year | City Taxes | County Taxes | Total Taxes |
|----------|------------|--------------|-------------|
| 2018 | | | \$210.35 |
| 2017 | | | \$207.55 |
| 2016 | | | \$188.73 |
| 2015 | | | \$188.21 |
| 2014 | | | \$185.88 |
| 2013 | | | \$182.91 |

MORTGAGE HISTORY

No mortgages were found for this parcel.

PROPERTY CHARACTERISTICS: BUILDING

No Buildings were found for this parcel.

PROPERTY CHARACTERISTICS: EXTRA FEATURES

No extra features were found for this parcel.

PROPERTY CHARACTERISTICS: LOT

| Land Use | Residential Vacant | Lot Dimensions |
|--------------------|------------------------|-----------------|
| Block/Lot | | Lot Square Feet |
| Latitude/Longitude | 34.610863°/-82.396070° | Acreage |

PROPERTY CHARACTERISTICS: UTILITIES/AREA

| Gas Source | | Road Type |
|-----------------|--|---------------------------|
| Electric Source | | Topography |
| Water Source | | District Trend |
| Sewer Source | | Special School District 1 |
| Zoning Code | | Special School District 2 |
| Owner Type | | |

LEGAL DESCRIPTION

| Subdivision | | Plat Book/Page |
|-------------|--|----------------|
| Block/Lot | | District/Ward |
| | | 1 |
| Description | | |

FEMA FLOOD ZONES

| Zone Code | Flood Risk | BFE | Description | FIRM Panel ID | FIRM Panel Eff. Date |
|-----------|------------|-----|--|---------------|----------------------|
| X | Minimal | | Area of minimal flood hazard, usually depicted on FIRMs as above the 500-year flood level. | 45045C0535E | 01/18/2019 |

LISTING ARCHIVE

| MLS # | Status | Status Change Date | List Date | List Price | Closing Date | Closing Price | Listing Agent | Listing Broker | Selling Agent | Selling Broker |
|---------|-----------|--------------------|------------|--------------|--------------|---------------|------------------|-----------------------------|---------------|----------------|
| 1183187 | Withdrawn | 09/23/2009 | 06/07/2009 | \$15,000,000 | | | Darlene D Luckey | Agape Real Estate Solutions | | |
| 1125406 | Expired | 02/06/2008 | 02/05/2007 | \$18,000 | | | Darlene D Luckey | J & I Properties, LLC | | |