

City of Chesapeake, Virginia

Parcel Number: 0254012000320
Property Address (Primary): 3020 S MILITARY HWY
 CHESAPEAKE , 23323
Parcel Class: 4353
Parcel Class Description: COMMERCIAL - RETAIL

Summary

Property Owner	UNITED STATES OF AMERICA
Owner Address Address	101 W MAIN ST STE 8000 NORFOLK , VA 23510
Zoning	B2: General Business
Acreage	0.408
Legal Description	32 BROADMOOR

Site Information

Neighborhood Number	0001
Neighborhood Description	COMMERCIAL
Borough:	DEEP CREEK
Building Name	FLAMINGO CREEK ANTIQUES
Frontage Length	100
Other Dimensions	XIRRG
Land Use Participant	No

Assessment Information

Date	Fiscal Year	Land Value	Land Use Value	Improvement Value	Total Value
7/1/2018	2019	\$122,400		\$44,300	\$166,700
7/1/2017	2018	\$122,400		\$40,000	\$162,400
7/1/2016	2017	\$110,000		\$44,900	\$154,900
7/1/2015	2016	\$110,000		\$44,900	\$154,900
7/1/2014	2015	\$110,000		\$46,400	\$156,400
7/1/2013	2014	\$110,000		\$46,800	\$156,800
7/1/2012	2013	\$105,000		\$46,800	\$151,800
7/1/2011	2012	\$105,000		\$49,400	\$154,400
7/1/2010	2011	\$105,000		\$33,000	\$138,000
7/1/2009	2010	\$105,000		\$33,000	\$138,000
7/1/2008	2009	\$95,000		\$33,000	\$128,000
7/1/2007	2008	\$90,000		\$30,600	\$120,600
7/1/2006	2007	\$75,000		\$30,600	\$105,600
7/1/2005	2006	\$70,000		\$30,200	\$100,200

Ownership Information

Buyer Name	Seller Name	Sale Date	Sale Amount	Deed Book	Deed Page	Map Book/Page
UNITED STATES OF AMERICA	HOEFLEIN RENTALS LLC	1/23/2019	\$	9982	701	26/4
HOEFLEIN RENTALS LLC	HOEFLEIN PROPERTIES LLC	10/21/2010	\$1	8242	772	00260004
HOEFLEIN PROPERTIES LLC	HOEFLEIN R J & HOEFLEIN G W SR	1/10/2005	\$	5792	9	00260004
HOEFLEIN R J & HOEFLEIN G W SR	N & H CORP	4/30/1993	\$73,000	2896	618	00260004
N & H CORP	RAKES GAIL BOYD	8/18/1989	\$58,800	2507	222	00260004
RAKES GAIL BOYD	RAKES FRANCES	6/6/1986	\$30,000	2191	490	00250020
RAKES FRANCES		7/8/1975	\$	1713	768	00250020

Commercial Improvement

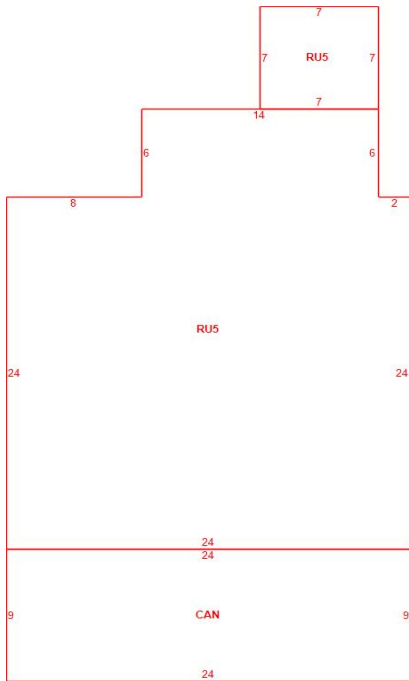

Year Built :	1940
Effecie Size:	709
Number of Stories :	
Elevator :	
Number of Elevators :	
HVAC/AC :	No HVAC
HVAC/AC 2 :	
HVAC/AC 3 :	

Front Wall :	Stud -Vinyl Siding
Front Wall 2:	
Side Wall :	Stud -Vinyl Siding
Side Wall 2 :	
Rear Wall :	Stud -Vinyl Siding
Rear Wall 2 :	
Sprinklers :	

Segments Information

Building # 1

Segment Code	Segment Description	Square Feet
CAN	CANOPY	216
RU5	503-RETAIL <5,000 SQFT	709

Outbuilding Information

Building Description	Year Built	Square Feet
STORAGE SHED (COM)	1960	312
LEAN-TO	1990	130
COMMERCIAL GARAGE	1990	384
STORAGE SHED (COM)	1900	704

Real Estate Tax

Current Year	Bill Number	Year	Installment	Date Due	Tax Billed	Tax Paid	Balance Due
2019	34673	2019	INSTALLMENT #1	10/1/2018	\$437.59	-\$437.59	\$1,312.77

DISCLAIMER: This data is provided without warranty of any kind, either expressed or implied, including but not limited to, the implied warranties of merchantability and fitness for a particular purpose. Any person, firm or corporation which uses this map or any of the enclosed information assumes all risk for the inaccuracy thereof, as City of Chesapeake expressly disclaims any liability for loss or damage arising from the use of said information by any third party.

2019	34673	2019	INSTALLMENT #2	1/2/2019	\$437.59	-\$437.59	\$875.18
2019	34673	2019	INSTALLMENT #3	4/1/2019	\$437.59	\$0.00	
2019	34673	2019	INSTALLMENT #4	6/5/2019	\$437.59	\$0.00	

Please contact the Treasurer's Office at (757) 382-6281 if you have questions regarding Tax Paid or Balance Due. Storm Water Fees and prior balances do not show on this tab.

Real Estate Notes

Note
1-DELETED FOR 88-89 TO COMM SYS
888- RAKES FRANCES G 070875 000000000 1713 768 0025 0020 000000000 000000000 00
999-DB8242 PG772 14 LOTS GIFT. INCLS 254(6)-9,57, 254(10)-9,16,254(12)-32,145B,154C,145D,145G,145H,145I, 34D(1)-9, 34D(2)-401,34E(4)-255.DAJ

DISCLAIMER: This data is provided without warranty of any kind, either expressed or implied, including but not limited to, the implied warranties of merchantability and fitness for a particular purpose. Any person, firm or corporation which uses this map or any of the enclosed information assumes all risk for the inaccuracy thereof, as City of Chesapeake expressly disclaims any liability for loss or damage arising from the use of said information by any third party.

City of Chesapeake, Virginia

Legend

- Parcels
- City Boundary

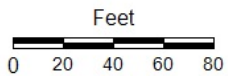
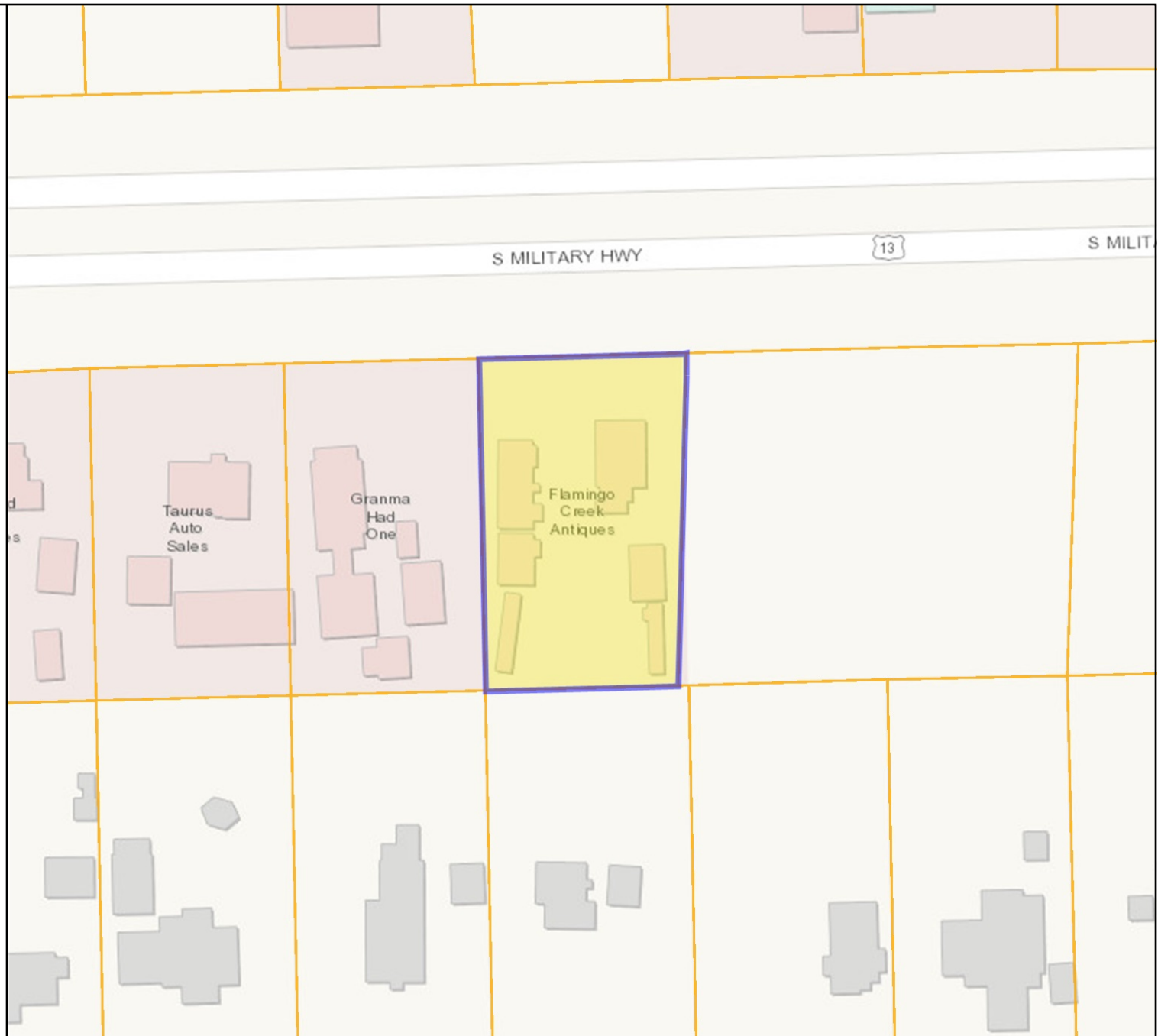

Parcel Number: 0254012000320

Date: 2/7/2019

DISCLAIMER: This drawing is neither a legally recorded map nor a survey and is not intended to be used as such. The information displayed is a compilation of records, information, and data obtained from various sources, and City of Chesapeake is not responsible for its accuracy or how current it may be.