

Map 009-00-00-028.00

PROPERTY CARD

Location **BALLARDSVILLE RD 07576**

Printed 3/2/2018

Building 1 RESIDENCE

Descr RES BLDGS & 47.60 ACRES

Yr Const 0

EffAge 0

BuildingVal 65,100

MH Vin

District 11-Com/Eminence Class Farm

Accoun 13943

Owner **BIBELHAUSER MARK ET AL**
C/O MARY FOWLER
7576 BALLARDSVILLE RD
SMITHFIELD KY 40068-

ResType	Single Family
MobType	
FarmTyp	
ComType	
ComTyp2	



Subdiv	Block	Lot
Date Checke 3/30/2015	Checked By JOE	Date Assessed 1/1/2015
Lot Size	LotSizeSqFt 0.00	LotEstActual
Frontage 0.00	Depth 0.00	Platt Book
Acreage 47.60	AcresEstAc	Source
Neighborhood	Site Conditio	Zoning
Road	Driveway	Sidewalks
Topography	Shape	Drainage
Flood Hazard	<input checked="" type="checkbox"/> Elect <input type="checkbox"/> Gas <input type="checkbox"/> Water <input type="checkbox"/> Sewer	Land Value 10,100

TenantHouses 0	Barns 0	Silos 0	GrainBins 0	Fencing 0
----------------	---------	---------	-------------	-----------

No Stories 1.00	Avg Heigh 0.00	Patio/Deck
MH/Manufact	MH/Model	MH/Skirting
Width 0.00	Length 0.00	Area 1,620.00
Garage/Carport None	GarType None	GarSize None
GarExterior None	Pool	PoolSize 0.00
Neighborhood	Site Cond	Bldg Cond
Structure 1 Story	Exterior Vinyl	Foundation Poured Concrete
Const.Type	Constr. Quality	Tennis Court
Roof Type Gable	Roof Cover Comp.Shingles	Roof Pitch

Basement Type None	BasementSize	BasementFinish Unfinished
<input checked="" type="checkbox"/> Heat/Type Heat Pump	Heat Source	SupplHeat
<input checked="" type="checkbox"/> Air/Type Central	Driveway	Sidewalks
<input checked="" type="checkbox"/> Electricity <input type="checkbox"/> Gas <input checked="" type="checkbox"/> Water <input type="checkbox"/> Sewer <input type="checkbox"/> Sprinklers	FireAlarm	SpecialImprvmt

Living 0	Dining 0	Family 0	Kitchn 0	BedRm 0	Bents 0	Living 1,620.00
FulBth 0	HlfBth 0	OthRm 0	Total 0	Firplc 0	Stalls 0	Basemt 0.00

Name	Deed	SaleDate	Sale Price
BIBELHAUSER MARK ET AL	267-915	06/18/2010	
BIBELHAUSER CHARLES	253-846	04/10/2007	0
BIBELHAUSER CHARLES & RUTH EST	131-379	01/01/1978	83,700

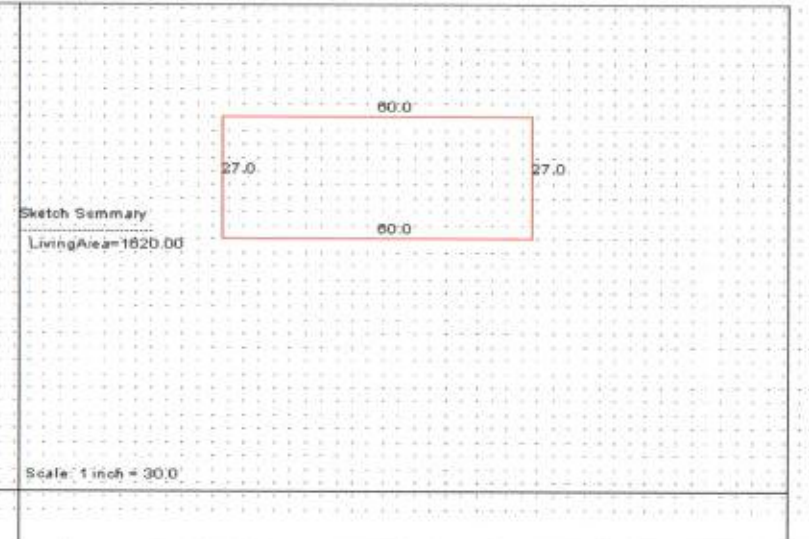

Year	Net Taxable	Exemption	Total Taxable	Land	Improvements	Ag Improvements	Land FCV	Imprvmts FCV	Ag Imprvmts FCV	Total FCV
2018	102,800	0	102,800	10,700	65,100	27,000	96,200	65,100	27,000	188,300
2017	102,800	0	102,800	10,700	65,100	27,000	96,200	65,100	27,000	188,300
2016	102,800	0	102,800	10,700	65,100	27,000	96,200	65,100	27,000	188,300