

531 N. 44th St., Louisville, KY 40212

Square footage calculation:

$$A = 14' \times 24' = 336$$

$$B = 11' \times 20' = 220$$

$$\text{Total square footage} = 556 \text{ sq. ft.}$$

Notes:

The square footage numbers constitute an approximation due to occasional rounding. Thus they are not guaranteed to be 100% accurate. Bidders are welcome to conduct their own measurements if the wish.

70
68
66
64
62
60
58
56
54
52
50
48
46
44
42
40
38
36
34
32
30
28
26
24
22
20
18
16
14
12
10
8
6
4
2

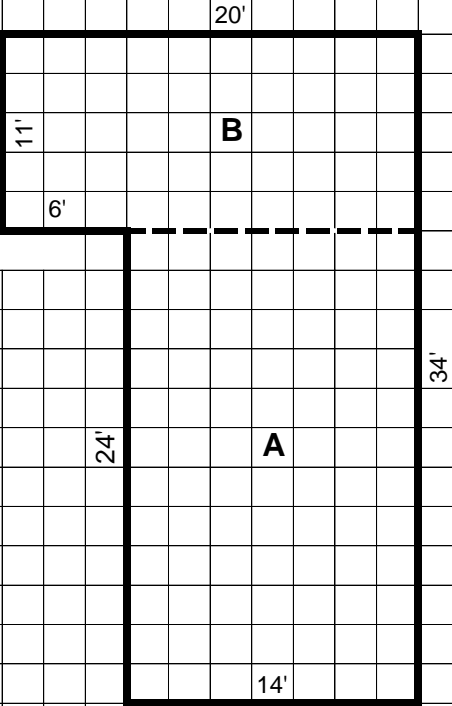

0 2 4 6 8 10 12 14 16 18 20 22 24 26 28 30 32 34 36 38 40 42 44 46 48 50 52 54 56 58 60